

FAN COIL UNIT

Features

General

- Fabricated with a rigid galvanized steel casing.
- The DIDW centrifugal fans have balanced, galvanized steel, and forward curved blades.
- Single skin galvanized steel casing with 5mm thickness, 27 kg/m³ high density non –flammable PE insulation.
- An optional return air plenum is available.

Coil

- The coil can have 3 or 4 rows, with copper tubes mechanically bonded into corrugated aluminum fin collars.
- Optional copper fin or hydrophilic blue fin is available.
- Water inlet / outlet connections are ¾-inch female pipe thread (BT).
- Header assembly is a one-piece casting, which enables to connect steel pipe directly.
- Coil assembly is tested over 20kg/cm² (300psig).
- A manual air vet is fitted with a drain line to the drain pan to avoid any water drips when venting.
- A water drain is located at the bottom of the coil header.

Fan Motor Assembly

- Standard galvanized steel fan wheel with optional aluminum fan wheel for low noise application.
- The motor comes with hermetic aluminum alloy casing and permanently lubricated ball bearing.
- The motor has grade F class insulation; with built-in thermal cutout.
- The motor lead-out wires are enclosed by flexible metal conduit, providing protection against damage.

Drain Pan

- The drain pan is 45mm depth with 0.8mm thickness galvanized steel completed with internal epoxy polyester resin coating.
- The drain pan is sloped towards the drain pipe with a 2 deg. gradient.
- The drain pan has one ½ inch male pipe thread (BT) connection.
- The standard insulation material is 5mm thickness, 27kg/m³ density PE foam.



Model Nomenclatures

F C 03 R 3 Y 3 W A

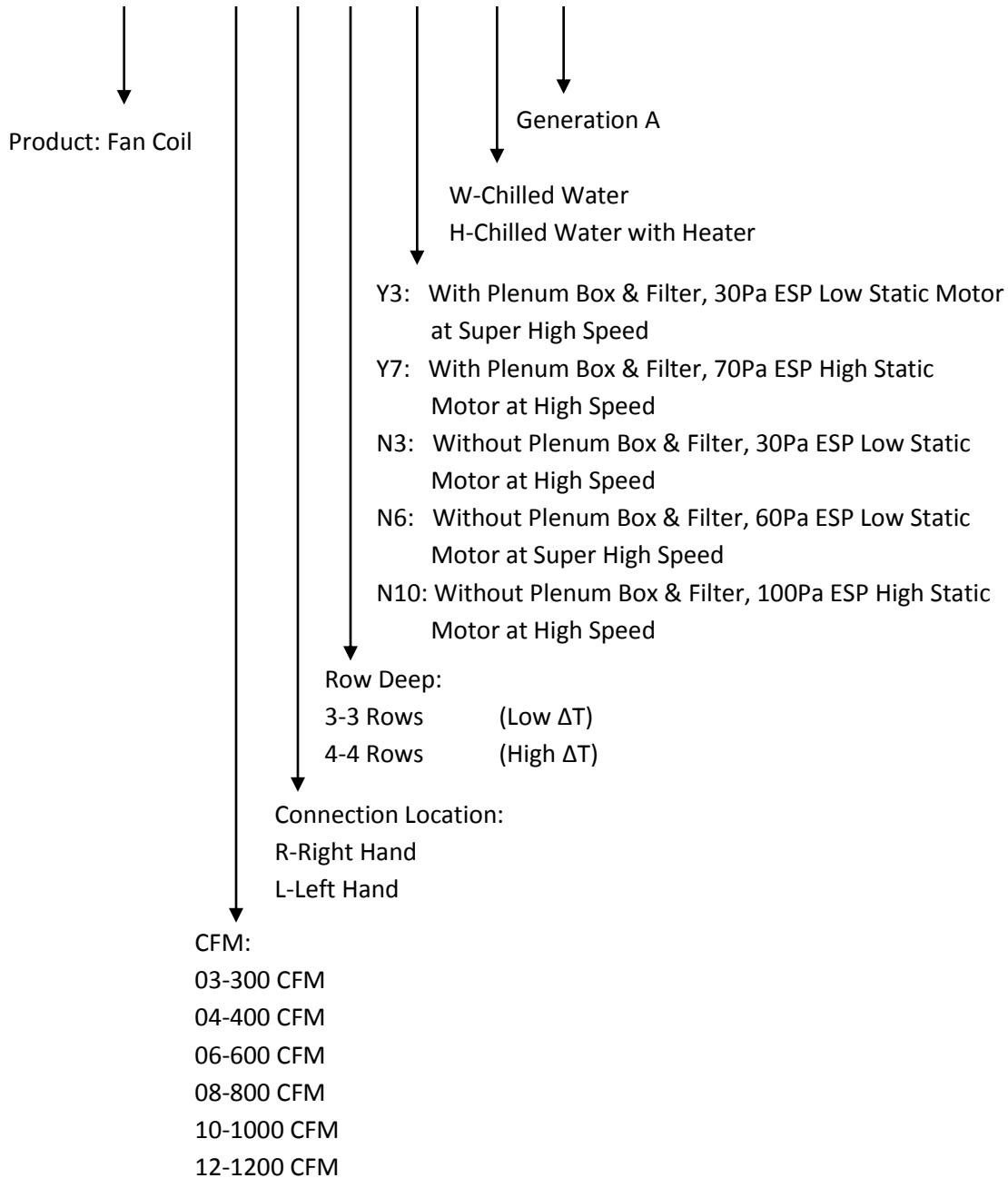



Model Selection Table

NO.	GROUP	PART NO.	ELITE DESCRIPTION
1	Low ΔT, Low Static Motor	85R8900111	FC03R3Y3WA
2		85R8900112	FC04R3Y3WA
3		85R8900113	FC06R3Y3WA
4		85R8900114	FC08R3Y3WA
5		85R8900115	FC10R3Y3WA
6		85R8900116	FC12R3Y3WA
7		85R8900117	FC03R3N3WA / FC03R3N6WA
8		85R8900118	FC04R3N3WA / FC04R3N6WA
9		85R8900119	FC06R3N3WA / FC06R3N6WA
10		85R8900120	FC08R3N3WA / FC08R3N6WA
11		85R8900121	FC10R3N3WA / FC10R3N6WA
12		85R8900122	FC12R3N3WA / FC12R3N6WA
13		85R8900123	FC03L3Y3WA
14		85R8900124	FC04L3Y3WA
15		85R8900125	FC06L3Y3WA
16		85R8900126	FC08L3Y3WA
17		85R8900127	FC10L3Y3WA
18		85R8900128	FC12L3Y3WA
19		85R8900129	FC03L3N3WA / FC03L3N6WA
20		85R8900130	FC04L3N3WA / FC04L3N6WA
21		85R8900131	FC06L3N3WA / FC06L3N6WA
22		85R8900132	FC08L3N3WA / FC08L3N6WA
23		85R8900133	FC10L3N3WA / FC10L3N6WA
24		85R8900134	FC12L3N3WA / FC12L3N6WA



**ELITE PRECISION COMPONENTS SDN. BHD.** (Company No: 220355-X)No. 40 & 42, Jalan Anggerik Mokara 31/47, Kota Kemuning, 40460 Shah Alam, Selangor D.E., Malaysia.
Tel: 603-5122 2893 Fax: 603-5122 5926/28 E-mail: info@eliteprecision.com Website: www.eliteprecision.com

NO.	GROUP	PART NO.	ELITE DESCRIPTION
25	High ΔT , Low Static Motor	85R8900135	FC03R4Y3WA
26		85R8900136	FC04R4Y3WA
27		85R8900137	FC06R4Y3WA
28		85R8900138	FC08R4Y3WA
29		85R8900139	FC10R4Y3WA
30		85R8900140	FC12R4Y3WA
31		85R8900141	FC03R4N3WA / FC03R4N6WA
32		85R8900142	FC04R4N3WA / FC04R4N6WA
33		85R8900143	FC06R4N3WA / FC06R4N6WA
34		85R8900144	FC08R4N3WA / FC08R4N6WA
35		85R8900145	FC10R4N3WA / FC10R4N6WA
36		85R8900146	FC12R4N3WA / FC12R4N6WA
37		85R8900147	FC03L4Y3WA
38		85R8900148	FC04L4Y3WA
39		85R8900149	FC06L4Y3WA
40		85R8900150	FC08L4Y3WA
41		85R8900151	FC10L4Y3WA
42		85R8900152	FC12L4Y3WA
43		85R8900153	FC03L4N3WA / FC03L4N6WA
44		85R8900154	FC04L4N3WA / FC04L4N6WA
45		85R8900155	FC06L4N3WA / FC06L4N6WA
46		85R8900156	FC08L4N3WA / FC08L4N6WA
47		85R8900157	FC10L4N3WA / FC10L4N6WA
48		85R8900158	FC12L4N3WA / FC12L4N6WA



**ELITE PRECISION COMPONENTS SDN. BHD.** (Company No: 220355-X)No. 40 & 42, Jalan Anggerik Mokara 31/47, Kota Kemuning, 40460 Shah Alam, Selangor D.E., Malaysia.
Tel: 603-5122 2893 Fax: 603-5122 5926/28 E-mail: info@eliteprecision.com Website: www.eliteprecision.com

NO.	GROUP	PART NO.	ELITE DESCRIPTION
49	Low ΔT , High Static Motor	85R8900159	FC03R3Y7WA
50		85R8900160	FC04R3Y7WA
51		85R8900161	FC06R3Y7WA
52		85R8900162	FC08R3Y7WA
53		85R8900163	FC10R3Y7WA
54		85R8900164	FC12R3Y7WA
55		85R8900165	FC03R3N10WA
56		85R8900166	FC04R3N10WA
57		85R8900167	FC06R3N10WA
58		85R8900168	FC08R3N10WA
59		85R8900169	FC10R3N10WA
60		85R8900170	FC12R3N10WA
61		85R8900071	FC03L3Y7WA
62		85R8900172	FC04L3Y7WA
63		85R8900173	FC06L3Y7WA
64		85R8900174	FC08L3Y7WA
65		85R8900175	FC10L3Y7WA
66		85R8900176	FC12L3Y7WA
67		85R8900177	FC03L3N10WA
68		85R8900178	FC04L3N10WA
69		85R8900179	FC06L3N10WA
70		85R8900180	FC08L3N10WA
71		85R8900181	FC10L3N10WA
72		85R8900182	FC12L3N10WA



**ELITE PRECISION COMPONENTS SDN. BHD.** (Company No: 220355-X)No. 40 & 42, Jalan Anggerik Mokara 31/47, Kota Kemuning, 40460 Shah Alam, Selangor D.E., Malaysia.
Tel: 603-5122 2893 Fax: 603-5122 5926/28 E-mail: info@eliteprecision.com Website: www.eliteprecision.com

NO.	GROUP	PART NO.	ELITE DESCRIPTION
73	High ΔT, High Static Motor	85R8900183	FC03R4Y7WA
74		85R8900184	FC04R4Y7WA
75		85R8900185	FC06R4Y7WA
76		85R8900186	FC08R4Y7WA
77		85R8900187	FC10R4Y7WA
78		85R8900188	FC12R4Y7WA
79		85R8900189	FC03R4N10WA
80		85R8900190	FC04R4N10WA
81		85R8900191	FC06R4N10WA
82		85R8900192	FC08R4N10WA
83		85R8900193	FC10R4N10WA
84		85R8900194	FC12R4N10WA
85		85R8900195	FC03L4Y7WA
86		85R8900196	FC04L4Y7WA
87		85R8900197	FC06L4Y7WA
88		85R8900198	FC08L4Y7WA
89		85R8900199	FC10L4Y7WA
90		85R8900200	FC12L4Y7WA
91		85R8900201	FC03L4N10WA
92		85R8900202	FC04L4N10WA
93		85R8900203	FC06L4N10WA
94		85R8900204	FC08L4N10WA
95		85R8900205	FC10L4N10WA
96		85R8900206	FC12L4N10WA





Performance Data (4 Row)

Model : FC03	EWT : Entering Water Temperature	Qs : Sensible Cooling Capacity, W	DT _w : Water Temperature Differences , °C
Cooling Row : 4	EAT : Entering Air Temperature	Qt : Total Cooling Capacity, W	DT _A : Air Temperature Differences , °C
Flow rate, GPM			

Imperial Unit: BTU/h, °F

EWT	EAT (DB/WB)	23 °C / 16 °C				27 °C / 19 °C				30 °C / 22 °C				33 °C / 25 °C				36 °C / 28 °C			
	°F	73.4 oF / 60.8 oF				80.6 °F / 66.2 °F				86 °F / 71.6 °F				91.4 °F / 77.0 °F				96.8 °F / 82.4 °F			
	GPM	DT _A <°F>	DT _w <°F>	Qs	Qt	DT _A <°F>	DT _w <°F>	Qs	Qt	DT _A <°F>	DT _w <°F>	Qs	Qt	DT _A <°F>	DT _w <°F>	Qs	Qt	DT _A <°F>	DT _w <°F>	Qs	Qt
4°C 39.2 °F	40%	15.30	24.12	5020	5191	15.30	29.70	5908	6352	18.72	34.20	6216	7343	19.08	38.88	6421	8333	19.44	43.56	6557	9358
	70%	18.90	18.54	6250	6933	18.90	23.04	7240	8606	22.86	27.18	7616	10177	23.40	31.68	7889	11851	23.76	36.36	8060	13558
	100%	20.88	15.12	6865	8026	20.88	19.08	8026	10143	25.38	23.04	8504	12226	26.46	27.18	8845	14412	27.00	31.32	9119	16700
	130%	22.14	12.78	7308	8845	22.14	16.38	8572	11270	27.36	19.98	9153	13763	28.62	23.76	9597	16393	29.52	27.72	9972	19159
	160%	23.04	11.16	7650	9460	23.04	14.22	8982	12158	28.98	17.64	9665	14958	30.42	21.06	10177	17896	31.50	24.66	10621	20969
7°C 44.6 °F	40%	13.68	20.88	4474	4474	13.68	25.56	5328	5498	17.28	30.06	5772	6455	18.00	34.74	6045	7445	18.54	39.42	6216	8470
	70%	16.56	15.30	5533	5703	16.56	19.62	6625	7343	21.06	23.76	7069	8879	21.96	28.08	7377	10485	22.50	32.58	7616	12192
	100%	18.36	12.24	6079	6489	18.36	16.02	7274	8538	23.40	19.80	7821	10553	24.48	23.94	8231	12739	25.38	28.08	8538	14993
	130%	19.44	10.26	6421	7035	19.44	13.68	7718	9426	25.02	17.10	8401	11851	26.46	20.88	8879	14446	27.54	24.84	9289	17213
	160%	20.16	8.82	6660	7479	20.16	11.88	8060	10109	26.28	15.12	8777	12841	27.90	18.54	9392	15812	29.16	22.14	9870	18886
10°C 50 °F	40%	11.16	17.28	3688	3688	11.16	22.50	4815	4815	15.84	26.10	5294	5601	16.92	30.60	5635	6557	17.46	35.28	5908	7582
	70%	14.40	12.78	4747	4747	14.40	16.20	5874	6079	19.44	20.16	5089	7548	20.52	24.48	6865	9119	21.24	28.98	7138	10792
	100%	16.02	9.90	5294	5294	16.02	12.96	6489	6933	21.42	16.56	7104	8845	22.68	20.52	7582	10963	23.58	24.84	7957	13217
	130%	16.20	7.74	5396	5396	16.20	10.98	6830	7548	22.68	14.22	7582	9870	24.30	18.00	8128	12397	25.38	21.96	8606	15129
	160%	16.92	6.66	5567	5601	16.92	9.36	7104	8026	23.58	12.60	7889	10655	25.56	16.02	8538	13558	27.00	19.62	9119	16666





ELITE PRECISION COMPONENTS SDN. BHD. (Company No: 220355-X)
 No. 40 & 42, Jalan Anggerik Mokara 31/47, Kota Kemuning, 40460 Shah Alam, Selangor D.E., Malaysia.
 Tel: 603-5122 2893 Fax: 603-5122 5926/28 E-mail: info@eliteprecision.com Website: www.eliteprecision.com

SI Unit: W, °C

EWT	EAT (DB/WB)	23 °C / 16 °C				27 °C / 19 °C				30 °C / 22 °C				33 °C / 25 °C				36 °C / 28 °C			
	°F	73.4 oF / 60.8 oF				80.6 °F / 66.2 °F				86 °F / 71.6 °F				91.4 °F / 77.0 °F				96.8 °F / 82.4 °F			
	GPM	DT _A <°C>	DT _W <°C>	Q _s	Q _t	DT _A <°C>	DT _W <°C>	Q _s	Q _t	DT _A <°C>	DT _W <°C>	Q _s	Q _t	DT _A <°C>	DT _W <°C>	Q _s	Q _t	DT _A <°C>	DT _W <°C>	Q _s	Q _t
4°C 39.2 °F	40%	8.50	13.40	1470	1520	8.50	16.50	1730	1860	10.40	19.00	1820	2150	10.60	21.60	1880	2440	10.80	24.20	1920	2740
	70%	10.50	10.30	1830	2030	10.50	12.80	2120	2520	12.70	15.10	2230	2980	13.00	17.60	2310	3470	13.20	20.20	2360	3970
	100%	11.60	8.40	2010	2350	11.60	10.60	2350	2970	14.10	12.80	2490	3580	14.70	15.10	2590	4220	15.00	17.40	2670	4890
	130%	12.30	7.10	2140	2590	12.30	9.10	2510	3300	15.20	11.10	2680	4030	15.90	13.20	2810	4800	16.40	15.40	2920	5610
	160%	12.80	6.20	2240	2770	12.80	7.90	2630	3560	16.10	9.80	2830	4380	16.90	11.70	2980	5240	17.50	13.70	3110	6140
7°C 44.6 °F	40%	7.60	11.60	1310	1310	7.60	14.20	1560	1610	9.60	16.70	1690	1890	10.00	19.30	1770	2180	10.30	21.90	1820	2480
	70%	9.20	8.50	1620	1670	9.20	10.90	1940	2150	11.70	13.20	2070	2600	12.20	15.60	2160	3070	12.50	18.10	2230	3570
	100%	10.20	6.80	1780	1900	10.20	8.90	2130	2500	13.00	11.00	2290	3090	13.60	13.30	2410	3730	14.10	15.60	2500	4390
	130%	10.80	5.70	1880	2060	10.80	7.60	2260	2760	13.90	9.50	2460	3470	14.70	11.60	2600	4230	15.30	13.80	2720	5040
	160%	11.20	4.90	1950	2190	11.20	6.60	2360	2960	14.60	8.40	2570	3760	15.50	10.30	2750	4630	16.20	12.30	2890	5530
10°C 50 °F	40%	6.20	9.60	1080	1080	6.20	12.50	1410	1410	8.80	14.50	1550	1640	9.40	17.00	1650	1920	9.70	19.60	1730	2220
	70%	8.00	7.10	1390	1390	8.00	9.00	1720	1780	10.80	11.20	1490	2210	11.40	13.60	2010	2670	11.80	16.10	2090	3160
	100%	8.90	5.50	1550	1550	8.90	7.20	1900	2030	11.90	9.20	2080	2590	12.60	11.40	2220	3210	13.10	13.80	2330	3870
	130%	9.00	4.30	1580	1580	9.00	6.10	2000	2210	12.60	7.90	2220	2890	13.50	10.00	2380	3630	14.10	12.20	2520	4430
	160%	9.40	3.70	1630	1640	9.40	5.20	2080	2350	13.10	7.00	2310	3120	14.20	8.90	2500	3970	15.00	10.90	2670	4880





ELITE PRECISION COMPONENTS SDN. BHD. (Company No: 220355-X)
 No. 40 & 42, Jalan Anggerik Mokara 31/47, Kota Kemuning, 40460 Shah Alam, Selangor D.E., Malaysia.
 Tel: 603-5122 2893 Fax: 603-5122 5926/28 E-mail: info@eliteprecision.com Website: www.eliteprecision.com

Model : FC04	EWT : Entering Water Temperature	Qs : Sensible Cooling Capacity, W	DT_w : Water Temperature Differences , °C
Cooling Row : 4	EAT : Entering Air Temperature	Qt : Total Cooling Capacity, W	DT_A : Air Temperature Differences , °C
Flow rate, GPM			

Imperial Unit: BTU/h, °F

EWT	EAT (DB/WB)	23 °C / 16 °C				27 °C / 19 °C				30 °C / 22 °C				33 °C / 25 °C				36 °C / 28 °C			
	°F	73.4 oF / 60.8 oF				80.6 °F / 66.2 °F				86 °F / 71.6 °F				91.4 °F / 77.0 °F				96.8 °F / 82.4 °F			
	GPM	DT _A <°F>	DT _w <°F>	Qs	Qt	DT _A <°F>	DT _w <°F>	Qs	Qt	DT _A <°F>	DT _w <°F>	Qs	Qt	DT _A <°F>	DT _w <°F>	Qs	Qt	DT _A <°F>	DT _w <°F>	Qs	Qt
4°C 39.2°F	40%	17.64	21.60	7821	8401	17.64	26.64	9050	10348	21.42	31.14	9494	12090	21.78	35.64	9802	13900	22.14	40.50	9972	15744
	70%	20.88	16.02	9255	10792	20.88	20.16	10792	13592	25.56	24.12	11373	16325	26.46	28.44	11851	19193	27.00	32.94	12192	22199
	100%	22.86	12.78	10075	12329	22.86	16.20	11817	15744	28.26	19.80	12636	19262	29.70	23.76	13285	22984	30.60	27.72	13797	26843
	130%	24.12	10.62	10621	13422	24.12	13.68	12534	17281	30.24	16.92	13524	21345	32.04	20.16	14310	25546	33.12	23.76	14958	29985
	160%	25.02	9.18	10997	14173	25.02	11.88	13046	18374	31.68	14.76	14105	22711	33.66	17.64	15027	27321	35.10	20.70	15812	32171
7°C 44.6°F	40%	15.66	18.00	6899	7001	15.66	22.86	8299	8914	19.80	27.18	8845	10587	20.52	31.68	9187	12363	21.06	36.54	9460	14207
	70%	18.54	12.96	8162	8743	18.54	16.92	9802	11475	23.58	20.88	10450	14105	24.66	25.20	11031	16973	25.38	29.52	11441	19945
	100%	19.98	10.08	8811	9802	19.98	13.50	10621	13148	25.92	17.10	11509	16564	27.36	20.88	12260	20252	28.44	24.84	12841	24145
	130%	20.88	8.28	9221	10553	20.88	11.34	11168	14310	27.54	14.58	12226	18305	29.34	17.82	13148	22608	30.78	21.42	13866	27048
	160%	21.60	7.20	9528	11099	21.60	9.72	11577	15198	28.62	12.60	12773	19603	30.78	15.66	13763	24214	32.40	18.72	14617	29097
10°C 50°F	40%	13.32	14.94	5840	5840	13.32	19.26	7377	7479	18.18	23.40	8128	9084	35.64	27.72	8606	10826	19.80	32.40	8914	12636
	70%	16.20	10.44	7104	7104	16.20	13.86	8743	9358	21.42	17.64	9563	11885	22.68	21.78	10177	14651	23.58	26.10	10655	17588
	100%	16.92	7.74	7445	7479	16.92	10.80	9426	10519	23.40	14.22	10416	13797	25.02	18.00	11202	17383	26.28	21.96	11885	21242
	130%	17.64	6.12	7787	7855	17.64	9.00	9870	11338	24.66	12.06	10963	15163	26.64	15.30	11953	19398	28.26	18.90	12773	23906
	160%	18.00	5.22	4440	7957	18.00	7.74	10143	11919	25.56	10.44	11373	16188	27.90	13.50	12500	20867	29.70	16.56	13388	25750





SI Unit: W, °C

EWT	EAT (DB/WB)	23 °C / 16 °C				27 °C / 19 °C				30 °C / 22 °C				33 °C / 25 °C				36 °C / 28 °C			
	°F	73.4 oF / 60.8 oF				80.6 °F / 66.2 °F				86 °F / 71.6 °F				91.4 °F / 77.0 °F				96.8 °F / 82.4 °F			
	GPM	DT _A <°C>	DT _W <°C>	Q _s	Q _t	DT _A <°C>	DT _W <°C>	Q _s	Q _t	DT _A <°C>	DT _W <°C>	Q _s	Q _t	DT _A <°C>	DT _W <°C>	Q _s	Q _t	DT _A <°C>	DT _W <°C>	Q _s	Q _t
4°C 39.2°F	40%	9.80	12.00	2290	2460	9.80	14.80	2650	3030	11.90	17.30	2780	3540	12.10	19.80	2870	4070	12.30	22.50	2920	4610
	70%	11.60	8.90	2710	3160	11.60	11.20	3160	3980	14.20	13.40	3330	4780	14.70	15.80	3470	5620	15.00	18.30	3570	6500
	100%	12.70	7.10	2950	3610	12.70	9.00	3460	4610	15.70	11.00	3700	5640	16.50	13.20	3890	6730	17.00	15.40	4040	7860
	130%	13.40	5.90	3110	3930	13.40	7.60	3670	5060	16.80	9.40	3960	6250	17.80	11.20	4190	7480	18.40	13.20	4380	8780
	160%	13.90	5.10	3220	4150	13.90	6.60	3820	5380	17.60	8.20	4130	6650	18.70	9.80	4400	8000	19.50	11.50	4630	9420
7°C 44.6°F	40%	8.70	10.00	2020	2050	8.70	12.70	2430	2610	11.00	15.10	2590	3100	11.40	17.60	2690	3620	11.70	20.30	2770	4160
	70%	10.30	7.20	2390	2560	10.30	9.40	2870	3360	13.10	11.60	3060	4130	13.70	14.00	3230	4970	14.10	16.40	3350	5840
	100%	11.10	5.60	2580	2870	11.10	7.50	3110	3850	14.40	9.50	3370	4850	15.20	11.60	3590	5930	15.80	13.80	3760	7070
	130%	11.60	4.60	2700	3090	11.60	6.30	3270	4190	15.30	8.10	3580	5360	16.30	9.90	3850	6620	17.10	11.90	4060	7920
	160%	12.00	4.00	2790	3250	12.00	5.40	3390	4450	15.90	7.00	3740	5740	17.10	8.70	4030	7090	18.00	10.40	4280	8520
10°C 50°F	40%	7.40	8.30	1710	1710	7.40	10.70	2160	2190	10.10	13.00	2380	2660	19.80	15.40	2520	3170	11.00	18.00	2610	3700
	70%	9.00	5.80	2080	2080	9.00	7.70	2560	2740	11.90	9.80	2800	3480	12.60	12.10	2980	4290	13.10	14.50	3120	5150
	100%	9.40	4.30	2180	2190	9.40	6.00	2760	3080	13.00	7.90	3050	4040	13.90	10.00	3280	5090	14.60	12.20	3480	6220
	130%	9.80	3.40	2280	2300	9.80	5.00	2890	3320	13.70	6.70	3210	4440	14.80	8.50	3500	5680	15.70	10.50	3740	7000
	160%	10.00	2.90	1300	2330	10.00	4.30	2970	3490	14.20	5.80	3330	4740	15.50	7.50	3660	6110	16.50	9.20	3920	7540





ELITE PRECISION COMPONENTS SDN. BHD. (Company No: 220355-X)
 No. 40 & 42, Jalan Anggerik Mokara 31/47, Kota Kemuning, 40460 Shah Alam, Selangor D.E., Malaysia.
 Tel: 603-5122 2893 Fax: 603-5122 5926/28 E-mail: info@eliteprecision.com Website: www.eliteprecision.com

Model : FC06	EWT : Entering Water Temperature	Qs : Sensible Cooling Capacity, W	DT _w : Water Temperature Differences , °C
Cooling Row : 4	EAT : Entering Air Temperature	Qt : Total Cooling Capacity, W	DT _A : Air Temperature Differences , °C
Flow rate, GPM			

Imperial Unit: BTU/h, °F

EWT	EAT (DB/WB)	23 °C / 16 °C				27 °C / 19 °C				30 °C / 22 °C				33 °C / 25 °C				36 °C / 28 °C			
	°F	73.4 oF / 60.8 oF				80.6 °F / 66.2 °F				86 °F / 71.6 °F				91.4 °F / 77.0 °F				96.8 °F / 82.4 °F			
	GPM	DT _A <°F>	DT _w <°F>	Qs	Qt	DT _A <°F>	DT _w <°F>	Qs	Qt	DT _A <°F>	DT _w <°F>	Qs	Qt	DT _A <°F>	DT _w <°F>	Qs	Qt	DT _A <°F>	DT _w <°F>	Qs	Qt
4°C 39.2°F	40%	16.74	22.68	11133	11885	16.74	27.90	12978	14651	20.34	32.58	13592	17042	20.88	37.26	14002	19501	21.06	42.12	14275	22062
	70%	20.16	16.92	13353	15402	20.16	21.24	15573	19364	24.48	25.38	16427	23189	25.38	29.70	17042	27185	25.92	34.38	17520	31385
	100%	21.96	13.50	14583	17622	21.96	17.28	17042	22438	27.18	21.06	18203	27356	28.44	25.02	19091	32581	29.34	29.16	19808	38045
	130%	23.22	11.34	15402	19193	23.22	14.58	18100	24658	29.16	18.00	19467	30395	30.60	21.42	20594	36372	31.68	25.20	21447	42621
	160%	24.12	9.72	15983	20354	24.12	12.60	18886	26297	29.16	15.66	20389	32513	32.22	18.72	21652	39035	33.66	22.14	22711	45934
7°C 44.6°F	40%	14.76	18.90	9767	9904	14.76	24.12	11817	12602	30.60	28.44	12636	14924	19.62	33.12	13183	17383	19.98	37.98	13524	19910
	70%	17.82	13.68	11782	12500	17.82	13.68	11782	12500	18.90	21.96	15095	20047	23.58	26.28	15881	24009	24.30	30.78	16427	28141
	100%	19.26	10.80	12773	14036	19.26	14.40	15368	18749	22.68	18.00	16632	23531	26.28	21.96	17656	28688	27.36	26.10	18442	34083
	130%	20.16	9.00	16803	15095	20.16	12.06	16188	20423	24.84	15.48	17656	26058	28.26	19.08	18954	32137	29.52	22.68	19910	38387
	160%	20.88	7.74	13831	15915	20.88	10.44	16803	21721	26.46	13.50	18476	27970	29.52	16.56	19842	34527	31.14	19.98	21003	41426
10°C 50°F	40%	12.60	15.84	8333	8333	12.60	20.34	10485	10621	27.54	24.48	11612	12841	18.36	28.98	12295	15232	18.90	33.84	12773	17725
	70%	15.48	11.34	10280	10280	15.48	14.58	12602	13388	17.28	18.54	13763	16871	21.60	22.68	14685	20730	22.68	27.18	15334	24794
	100%	16.20	8.28	10690	10724	16.20	11.52	13627	15027	22.50	14.94	14993	19569	23.40	18.90	16154	24623	25.20	23.04	17076	29951
	130%	16.92	6.66	11202	11270	16.92	9.54	14241	16188	23.76	12.78	15846	21550	25.56	16.20	17213	27492	27.18	19.98	18374	33844
	160%	17.46	5.58	5362	11543	17.46	8.28	14685	17042	24.66	11.16	16495	23087	26.82	14.22	18032	29712	26.82	17.64	19296	36611





ELITE PRECISION COMPONENTS SDN. BHD. (Company No: 220355-X)
 No. 40 & 42, Jalan Anggerik Mokara 31/47, Kota Kemuning, 40460 Shah Alam, Selangor D.E., Malaysia.
 Tel: 603-5122 2893 Fax: 603-5122 5926/28 E-mail: info@eliteprecision.com Website: www.eliteprecision.com

SI Unit: W, °C

EWT	EAT (DB/WB)	23 °C / 16 °C				27 °C / 19 °C				30 °C / 22 °C				33 °C / 25 °C				36 °C / 28 °C			
	°F	73.4 oF / 60.8 oF				80.6 °F / 66.2 °F				86 °F / 71.6 °F				91.4 °F / 77.0 °F				96.8 °F / 82.4 °F			
	GPM	DT _A <°C>	DT _w <°C>	Q _s	Q _t	DT _A <°C>	DT _w <°C>	Q _s	Q _t	DT _A <°C>	DT _w <°C>	Q _s	Q _t	DT _A <°C>	DT _w <°C>	Q _s	Q _t	DT _A <°C>	DT _w <°C>	Q _s	Q _t
4°C 39.2°F	40%	9.30	12.60	3260	3480	9.30	15.50	3800	4290	11.30	18.10	3980	4990	11.60	20.70	4100	5710	11.70	23.40	4180	6460
	70%	11.20	9.40	3910	4510	11.20	11.80	4560	5670	13.60	14.10	4810	6790	14.10	16.50	4990	7960	14.40	19.10	5130	9190
	100%	12.20	7.50	4270	5160	12.20	9.60	4990	6570	15.10	11.70	5330	8010	15.80	13.90	5590	9540	16.30	16.20	5800	11140
	130%	12.90	6.30	4510	5620	12.90	8.10	5300	7220	16.20	10.00	5700	8900	17.00	11.90	6030	10650	17.60	14.00	6280	12480
	160%	13.40	5.40	4680	5960	13.40	7.00	5530	7700	16.20	8.70	5970	9520	17.90	10.40	6340	11430	18.70	12.30	6650	13450
7°C 44.6°F	40%	8.20	10.50	2860	2900	8.20	13.40	3460	3690	17.00	15.80	3700	4370	10.90	18.40	3860	5090	11.10	21.10	3960	5830
	70%	9.90	7.60	3450	3660	9.90	7.60	3450	3660	10.50	12.20	4420	5870	13.10	14.60	4650	7030	13.50	17.10	4810	8240
	100%	10.70	6.00	3740	4110	10.70	8.00	4500	5490	12.60	10.00	4870	6890	14.60	12.20	5170	8400	15.20	14.50	5400	9980
	130%	11.20	5.00	4920	4420	11.20	6.70	4740	5980	13.80	8.60	5170	7630	15.70	10.60	5550	9410	16.40	12.60	5830	11240
	160%	11.60	4.30	4050	4660	11.60	5.80	4920	6360	14.70	7.50	5410	8190	16.40	9.20	5810	10110	17.30	11.10	6150	12130
10°C 50°F	40%	7.00	8.80	2440	2440	7.00	11.30	3070	3110	15.30	13.60	3400	3760	10.20	16.10	3600	4460	10.50	18.80	3740	5190
	70%	8.60	6.30	3010	3010	8.60	8.10	3690	3920	9.60	10.30	4030	4940	12.00	12.60	4300	6070	12.60	15.10	4490	7260
	100%	9.00	4.60	3130	3140	9.00	6.40	3990	4400	12.50	8.30	4390	5730	13.00	10.50	4730	7210	14.00	12.80	5000	8770
	130%	9.40	3.70	3280	3300	9.40	5.30	4170	4740	13.20	7.10	4640	6310	14.20	9.00	5040	8050	15.10	11.10	5380	9910
	160%	9.70	3.10	1570	3380	9.70	4.60	4300	4990	13.70	6.20	4830	6760	14.90	7.90	5280	8700	14.90	9.80	5650	10720





ELITE PRECISION COMPONENTS SDN. BHD. (Company No: 220355-X)
 No. 40 & 42, Jalan Anggerik Mokara 31/47, Kota Kemuning, 40460 Shah Alam, Selangor D.E., Malaysia.
 Tel: 603-5122 2893 Fax: 603-5122 5926/28 E-mail: info@eliteprecision.com Website: www.eliteprecision.com

Model : FC08	EWT : Entering Water Temperature	Qs : Sensible Cooling Capacity, W	DT_w : Water Temperature Differences , °C
Cooling Row : 4	EAT : Entering Air Temperature	Qt : Total Cooling Capacity, W	DT_A : Air Temperature Differences , °C
Flow rate, GPM			

Imperial Unit: BTU/h, °F

EWT	EAT (DB/WB)	23 °C / 16 °C				27 °C / 19 °C				30 °C / 22 °C				33 °C / 25 °C				36 °C / 28 °C			
	°F	73.4 oF / 60.8 oF				80.6 °F / 66.2 °F				86 °F / 71.6 °F				91.4 °F / 77.0 °F				96.8 °F / 82.4 °F			
	GPM	DT _A <°F>	DT _w <°F>	Qs	Qt	DT _A <°F>	DT _w <°F>	Qs	Qt	DT _A <°F>	DT _w <°F>	Qs	Qt	DT _A <°F>	DT _w <°F>	Qs	Qt	DT _A <°F>	DT _w <°F>	Qs	Qt
4°C 39.2 °F	40%	15.30	24.48	13592	14139	15.30	29.88	15881	17315	18.72	34.38	16700	19979	19.26	39.24	17213	22745	19.44	44.10	17554	25580
	70%	18.90	18.54	16769	18783	18.90	23.04	19501	23428	23.04	27.36	20491	27800	23.76	31.86	21208	32342	24.12	36.54	21721	37089
	100%	20.88	14.94	18476	21755	20.88	18.90	21584	27526	25.56	22.86	22882	33264	26.64	27.00	23872	39309	27.36	31.32	24623	45661
	130%	22.14	12.60	19603	23872	22.14	16.20	22984	30498	27.54	19.80	24589	37328	28.98	23.58	25887	44602	29.88	27.54	26843	52081
	160%	23.22	10.98	20457	25511	23.22	14.04	24077	32786	29.16	17.46	25921	40470	30.60	20.88	27390	48427	31.68	24.48	28551	56760
7°C 44.6 °F	40%	13.86	21.06	12226	12226	13.86	25.92	14446	14993	17.46	30.42	15539	17622	18.18	35.10	16222	20320	18.54	39.96	16700	23155
	70%	16.74	15.12	14822	15402	16.74	19.62	17759	19910	21.24	23.76	18954	24145	22.14	28.08	19808	28619	22.68	32.76	20457	33298
	100%	18.36	12.06	16256	17486	18.36	15.84	19501	23087	23.58	19.62	20969	28653	24.66	23.76	22130	34630	25.56	28.08	23018	40914
	130%	19.44	10.08	17144	18954	19.44	13.50	20662	25409	25.20	16.92	22404	32069	26.64	20.70	23838	39206	27.72	24.84	24999	46788
	160%	20.16	8.64	17759	20047	20.16	11.70	21516	27151	26.46	14.94	23531	34698	28.08	18.36	25204	42792	29.52	21.96	26502	51125
10°C 50 °F	40%	11.34	17.28	10006	10006	11.34	22.50	13080	13080	16.02	26.28	14207	15198	17.10	30.78	15163	17896	17.46	35.64	15778	20662
	70%	14.58	12.60	12807	12807	14.58	16.20	15846	16461	19.44	20.16	17349	20457	20.52	24.48	18408	24828	21.24	28.98	19193	29439
	100%	12.42	12.78	17349	18715	12.42	12.78	17349	18715	21.42	16.56	19091	24009	22.68	20.52	20389	29815	23.76	24.84	21413	35996
	130%	16.20	7.56	14344	14378	16.20	10.80	18271	20286	22.68	14.04	20218	26638	24.30	17.82	21823	33640	25.56	21.78	23121	41119
	160%	16.74	6.48	5601	14856	16.74	9.18	18920	21481	23.58	12.42	21106	28688	25.56	15.66	22916	36645	27.18	19.44	24453	45115





ELITE PRECISION COMPONENTS SDN. BHD. (Company No: 220355-X)
 No. 40 & 42, Jalan Anggerik Mokara 31/47, Kota Kemuning, 40460 Shah Alam, Selangor D.E., Malaysia.
 Tel: 603-5122 2893 Fax: 603-5122 5926/28 E-mail: info@eliteprecision.com Website: www.eliteprecision.com

SI Unit: W, °C

EWT	EAT (DB/WB)	23 °C / 16 °C				27 °C / 19 °C				30 °C / 22 °C				33 °C / 25 °C				36 °C / 28 °C			
	°F	73.4 oF / 60.8 oF				80.6 °F / 66.2 °F				86 °F / 71.6 °F				91.4 °F / 77.0 °F				96.8 °F / 82.4 °F			
	GPM	DT _A <°C>	DT _w <°C>	Q _s	Q _t	DT _A <°C>	DT _w <°C>	Q _s	Q _t	DT _A <°C>	DT _w <°C>	Q _s	Q _t	DT _A <°C>	DT _w <°C>	Q _s	Q _t	DT _A <°C>	DT _w <°C>	Q _s	Q _t
4 °C 39.2 °F	40%	8.50	13.60	3980	4140	8.50	16.60	4650	5070	10.40	19.10	4890	5850	10.70	21.80	5040	6660	10.80	24.50	5140	7490
	70%	10.50	10.30	4910	5500	10.50	12.80	5710	6860	12.80	15.20	6000	8140	13.20	17.70	6210	9470	13.40	20.30	6360	10860
	100%	11.60	8.30	5410	6370	11.60	10.50	6320	8060	14.20	12.70	6700	9740	14.80	15.00	6990	11510	15.20	17.40	7210	13370
	130%	12.30	7.00	5740	6990	12.30	9.00	6730	8930	15.30	11.00	7200	10930	16.10	13.10	7580	13060	16.60	15.30	7860	15250
	160%	12.90	6.10	5990	7470	12.90	7.80	7050	9600	16.20	9.70	7590	11850	17.00	11.60	8020	14180	17.60	13.60	8360	16620
7 °C 44.6 °F	40%	7.70	11.70	3580	3580	7.70	14.40	4230	4390	9.70	16.90	4550	5160	10.10	19.50	4750	5950	10.30	22.20	4890	6780
	70%	9.30	8.40	4340	4510	9.30	10.90	5200	5830	11.80	13.20	5550	7070	12.30	15.60	5800	8380	12.60	18.20	5990	9750
	100%	10.20	6.70	4760	5120	10.20	8.80	5710	6760	13.10	10.90	6140	8390	13.70	13.20	6480	10140	14.20	15.60	6740	11980
	130%	10.80	5.60	5020	5550	10.80	7.50	6050	7440	14.00	9.40	6560	9390	14.80	11.50	6980	11480	15.40	13.80	7320	13700
	160%	11.20	4.80	5200	5870	11.20	6.50	6300	7950	14.70	8.30	6890	10160	15.60	10.20	7380	12530	16.40	12.20	7760	14970
10 °C 50 °F	40%	6.30	9.60	2930	2930	6.30	12.50	3830	3830	8.90	14.60	4160	4450	9.50	17.10	4440	5240	9.70	19.80	4620	6050
	70%	8.10	7.00	3750	3750	8.10	9.00	4640	4820	10.80	11.20	5080	5990	11.40	13.60	5390	7270	11.80	16.10	5620	8620
	100%	6.90	7.10	5080	5480	6.90	7.10	5080	5480	11.90	9.20	5590	7030	12.60	11.40	5970	8730	13.20	13.80	6270	10540
	130%	9.00	4.20	4200	4210	9.00	6.00	5350	5940	12.60	7.80	5920	7800	13.50	9.90	6390	9850	14.20	12.10	6770	12040
	160%	9.30	3.60	1640	4350	9.30	5.10	5540	6290	13.10	6.90	6180	8400	14.20	8.70	6710	10730	15.10	10.80	7160	13210





ELITE PRECISION COMPONENTS SDN. BHD. (Company No: 220355-X)
 No. 40 & 42, Jalan Anggerik Mokara 31/47, Kota Kemuning, 40460 Shah Alam, Selangor D.E., Malaysia.
 Tel: 603-5122 2893 Fax: 603-5122 5926/28 E-mail: info@eliteprecision.com Website: www.eliteprecision.com

Model : FC10	EWT : Entering Water Temperature	Qs : Sensible Cooling Capacity, W	DT _w : Water Temperature Differences , °C
Cooling Row : 4	EAT : Entering Air Temperature	Qt : Total Cooling Capacity, W	DT _A : Air Temperature Differences , °C
Flow rate, GPM			

Imperial Unit: BTU/h, °F

EWT	EAT (DB/WB)	23 °C / 16 °C				27 °C / 19 °C				30 °C / 22 °C				33 °C / 25 °C				36 °C / 28 °C			
	°F	73.4 °F / 60.8 °F				80.6 °F / 66.2 °F				86 °F / 71.6 °F				91.4 °F / 77.0 °F				96.8 °F / 82.4 °F			
	GPM	DT _A <°F>	DT _w <°F>	Qs	Qt	DT _A <°F>	DT _w <°F>	Qs	Qt	DT _A <°F>	DT _w <°F>	Qs	Qt	DT _A <°F>	DT _w <°F>	Qs	Qt	DT _A <°F>	DT _w <°F>	Qs	Qt
4°C 39.2 °F	40%	15.66	22.86	17417	18203	15.66	28.08	20320	22335	19.26	32.58	21345	25887	19.62	37.26	22028	29575	19.44	42.30	21960	33605
	70%	19.08	17.10	21140	23804	20.88	21.42	24623	29815	23.22	25.56	25921	35518	23.94	29.88	26877	41529	23.76	34.92	26809	48427
	100%	22.50	13.86	23189	27390	22.50	17.46	27082	34767	25.74	21.24	28756	42177	26.82	25.20	30122	50067	26.82	29.88	30258	59492
	130%	22.14	11.52	24521	29951	22.14	14.94	28790	38352	27.72	18.18	30839	47129	28.98	21.78	32513	56350	29.16	26.10	32888	67518
	160%	23.04	10.08	25546	31898	23.04	12.96	30054	41085	29.16	16.02	32410	50784	30.60	19.08	34288	60824	30.78	23.04	34903	73426
7°C 44.6 °F	40%	13.68	19.08	15163	15232	13.68	24.30	18476	19296	17.82	28.62	19842	22745	18.54	33.30	20764	26399	18.54	38.16	20901	30361
	70%	16.92	14.04	18647	19432	16.92	18.18	22369	25238	21.42	22.14	23940	30805	22.32	26.46	25102	36713	22.32	31.32	25306	43475
	100%	18.36	10.98	20320	21925	18.36	14.58	24453	29097	23.58	18.18	26365	36303	24.84	22.14	27902	44090	25.02	26.82	28346	53277
	130%	19.26	9.18	21379	23667	19.26	12.42	25819	31864	25.20	15.66	28073	40402	26.82	19.26	29951	49623	27.18	23.58	30668	60756
	160%	19.98	7.92	22130	24999	19.98	10.62	26843	33981	26.46	13.68	29405	43578	28.08	16.92	31522	53755	26.82	20.88	32444	66186
10°C 50 °F	40%	11.70	16.20	12875	12875	11.70	21.24	16871	16871	16.38	24.66	18203	19603	17.10	29.34	19125	23292	17.46	34.02	19774	27048
	70%	14.58	11.70	16188	16188	14.58	14.94	19945	20798	19.62	18.72	21891	26024	20.34	23.04	22882	32137	21.06	27.54	23735	38352
	100%	15.30	8.46	16939	16939	15.30	11.88	21721	23462	21.42	15.30	23906	30293	22.50	19.44	25204	38489	23.40	23.58	26365	46822
	130%	16.20	7.02	17861	17896	16.20	9.72	22813	25341	22.68	12.96	25306	33503	23.94	16.74	26946	43407	25.20	20.70	28414	53448
	160%	16.74	5.76	6079	18442	16.74	8.46	23565	26775	23.58	11.34	26331	35962	25.20	14.94	28244	47266	26.46	18.36	29951	58434





ELITE PRECISION COMPONENTS SDN. BHD. (Company No: 220355-X)
 No. 40 & 42, Jalan Anggerik Mokara 31/47, Kota Kemuning, 40460 Shah Alam, Selangor D.E., Malaysia.
 Tel: 603-5122 2893 Fax: 603-5122 5926/28 E-mail: info@eliteprecision.com Website: www.eliteprecision.com

SI Unit: W, °C

EWT	EAT (DB/WB)	23 °C / 16 °C				27 °C / 19 °C				30 °C / 22 °C				33 °C / 25 °C				36 °C / 28 °C			
	°F	73.4 oF / 60.8 oF				80.6 °F / 66.2 °F				86 °F / 71.6 °F				91.4 °F / 77.0 °F				96.8 °F / 82.4 °F			
	GPM	DT _A <°C>	DT _w <°C>	Q _s	Q _t	DT _A <°C>	DT _w <°C>	Q _s	Q _t	DT _A <°C>	DT _w <°C>	Q _s	Q _t	DT _A <°C>	DT _w <°C>	Q _s	Q _t	DT _A <°C>	DT _w <°C>	Q _s	Q _t
4°C 39.2 °F	40%	8.70	12.70	5100	5330	8.70	15.60	5950	6540	10.70	18.10	6250	7580	10.90	20.70	6450	8660	10.80	23.50	6430	9840
	70%	10.60	9.50	6190	6970	11.60	11.90	7210	8730	12.90	14.20	7590	10400	13.30	16.60	7870	12160	13.20	19.40	7850	14180
	100%	12.50	7.70	6790	8020	12.50	9.70	7930	10180	14.30	11.80	8420	12350	14.90	14.00	8820	14660	14.90	16.60	8860	17420
	130%	12.30	6.40	7180	8770	12.30	8.30	8430	11230	15.40	10.10	9030	13800	16.10	12.10	9520	16500	16.20	14.50	9630	19770
	160%	12.80	5.60	7480	9340	12.80	7.20	8800	12030	16.20	8.90	9490	14870	17.00	10.60	10040	17810	17.10	12.80	10220	21500
7°C 44.6 °F	40%	7.60	10.60	4440	4460	7.60	13.50	5410	5650	9.90	15.90	5810	6660	10.30	18.50	6080	7730	10.30	21.20	6120	8890
	70%	9.40	7.80	5460	5690	9.40	10.10	6550	7390	11.90	12.30	7010	9020	12.40	14.70	7350	10750	12.40	17.40	7410	12730
	100%	10.20	6.10	5950	6420	10.20	8.10	7160	8520	13.10	10.10	7720	10630	13.80	12.30	8170	12910	13.90	14.90	8300	15600
	130%	10.70	5.10	6260	6930	10.70	6.90	7560	9330	14.00	8.70	8220	11830	14.90	10.70	8770	14530	15.10	13.10	8980	17790
	160%	11.10	4.40	6480	7320	11.10	5.90	7860	9950	14.70	7.60	8610	12760	15.60	9.40	9230	15740	14.90	11.60	9500	19380
10°C 50 °F	40%	6.50	9.00	3770	3770	6.50	11.80	4940	4940	9.10	13.70	5330	5740	9.50	16.30	5600	6820	9.70	18.90	5790	7920
	70%	8.10	6.50	4740	4740	8.10	8.30	5840	6090	10.90	10.40	6410	7620	11.30	12.80	6700	9410	11.70	15.30	6950	11230
	100%	8.50	4.70	4960	4960	8.50	6.60	6360	6870	11.90	8.50	7000	8870	12.50	10.80	7380	11270	13.00	13.10	7720	13710
	130%	9.00	3.90	5230	5240	9.00	5.40	6680	7420	12.60	7.20	7410	9810	13.30	9.30	7890	12710	14.00	11.50	8320	15650
	160%	9.30	3.20	1780	5400	9.30	4.70	6900	7840	13.10	6.30	7710	10530	14.00	8.30	8270	13840	14.70	10.20	8770	17110





ELITE PRECISION COMPONENTS SDN. BHD. (Company No: 220355-X)
 No. 40 & 42, Jalan Anggerik Mokara 31/47, Kota Kemuning, 40460 Shah Alam, Selangor D.E., Malaysia.
 Tel: 603-5122 2893 Fax: 603-5122 5926/28 E-mail: info@eliteprecision.com Website: www.eliteprecision.com

Model : FC12	EWT : Entering Water Temperature	Qs : Sensible Cooling Capacity, W	DT _w : Water Temperature Differences , °C
Cooling Row : 4	EAT : Entering Air Temperature	Qt : Total Cooling Capacity, W	DT _A : Air Temperature Differences , °C
Flow rate, GPM			

Imperial Unit: BTU/h, °F

EWT	EAT (DB/WB)	23 °C / 16 °C				27 °C / 19 °C				30 °C / 22 °C				33 °C / 25 °C				36 °C / 28 °C			
	°F	73.4 oF / 60.8 oF				80.6 °F / 66.2 °F				86 °F / 71.6 °F				91.4 °F / 77.0 °F				96.8 °F / 82.4 °F			
	GPM	DT _A <°F>	DT _w <°F>	Qs	Qt	DT _A <°F>	DT _w <°F>	Qs	Qt	DT _A <°F>	DT _w <°F>	Qs	Qt	DT _A <°F>	DT _w <°F>	Qs	Qt	DT _A <°F>	DT _w <°F>	Qs	Qt
4°C 39.2 °F	40%	15.48	24.12	20491	21584	15.48	29.52	23838	26502	17.28	35.46	23189	26980	19.08	39.06	25580	35006	19.08	43.92	25921	39479
	70%	18.90	18.18	25102	28517	20.16	22.68	29029	35723	22.68	27.18	30395	42587	23.22	31.68	31317	49793	23.58	36.36	31864	57273
	100%	20.70	14.76	27595	32956	20.70	18.72	32034	41904	25.38	22.68	33879	50954	26.10	27.00	35176	60551	26.64	31.50	36064	70626
	130%	22.14	12.42	29234	36133	22.14	15.84	34152	46446	27.18	19.62	36406	57204	28.26	23.58	38113	68645	29.16	27.54	39275	80530
	160%	22.86	10.62	30429	38523	22.86	13.86	35723	49896	28.62	17.28	38318	61917	29.70	20.70	38557	74485	30.78	24.48	41733	87770
7°C 44.6 °F	40%	13.50	20.16	17896	18032	13.50	25.56	21721	22882	17.82	30.06	23189	26980	17.82	34.74	24111	31249	18.18	39.78	24658	35654
	70%	16.74	14.76	22130	23257	16.74	19.26	26468	30293	21.06	23.40	28141	36918	21.78	27.90	29268	43988	22.14	32.58	30054	51398
	100%	18.18	11.70	24248	26399	18.18	15.66	28995	35074	23.22	19.44	31078	43851	24.30	23.76	32649	53277	24.84	28.08	33742	63215
	130%	19.26	9.72	25511	28551	19.26	13.14	30668	38557	24.84	16.74	33161	49042	26.10	20.70	35142	60380	27.00	24.84	36611	72368
	160%	19.98	8.46	26433	30224	19.26	11.52	31932	41255	25.92	14.76	34767	53072	27.54	18.18	37055	65776	28.62	21.96	38762	79027
10°C 50 °F	40%	11.52	16.92	15232	15232	11.52	21.60	19193	19330	15.84	25.92	21311	23257	16.74	30.60	22540	27424	17.28	35.46	23326	31795
	70%	15.48	12.24	19330	19330	15.48	15.84	23667	24931	19.26	19.80	25785	31215	20.16	24.12	27219	38079	20.88	28.80	28209	45354
	100%	15.30	9.00	20286	20320	15.30	12.60	25785	28278	21.06	16.20	28244	36611	22.32	20.34	30054	45763	23.22	24.66	31454	55565
	130%	16.20	7.38	21379	21516	16.20	10.44	27117	30668	22.32	13.86	29917	40641	23.94	17.64	32171	51706	25.02	21.78	33879	63556
	160%	16.74	6.12	22096	22335	16.74	9.00	28107	32513	23.22	12.24	31215	43817	25.02	15.66	33776	56385	26.46	19.44	35791	69704





ELITE PRECISION COMPONENTS SDN. BHD. (Company No: 220355-X)
 No. 40 & 42, Jalan Anggerik Mokara 31/47, Kota Kemuning, 40460 Shah Alam, Selangor D.E., Malaysia.
 Tel: 603-5122 2893 Fax: 603-5122 5926/28 E-mail: info@eliteprecision.com Website: www.eliteprecision.com

SI Unit: W, °C

EWT	EAT (DB/WB)	23 °C / 16 °C				27 °C / 19 °C				30 °C / 22 °C				33 °C / 25 °C				36 °C / 28 °C			
	°F	73.4 oF / 60.8 oF				80.6 °F / 66.2 °F				86 °F / 71.6 °F				91.4 °F / 77.0 °F				96.8 °F / 82.4 °F			
	GPM	DT _A <°C>	DT _w <°C>	Q _s	Q _t	DT _A <°C>	DT _w <°C>	Q _s	Q _t	DT _A <°C>	DT _w <°C>	Q _s	Q _t	DT _A <°C>	DT _w <°C>	Q _s	Q _t	DT _A <°C>	DT _w <°C>	Q _s	Q _t
4°C 39.2°F	40%	8.60	13.40	6000	6320	8.60	16.40	6980	7760	9.60	19.70	6790	7900	10.60	21.70	7490	10250	10.60	24.40	7590	11560
	70%	10.50	10.10	7350	8350	11.20	12.60	8500	10460	12.60	15.10	8900	12470	12.90	17.60	9170	14580	13.10	20.20	9330	16770
	100%	11.50	8.20	8080	9650	11.50	10.40	9380	12270	14.10	12.60	9920	14920	14.50	15.00	10300	17730	14.80	17.50	10560	20680
	130%	12.30	6.90	8560	10580	12.30	8.80	10000	13600	15.10	10.90	10660	16750	15.70	13.10	11160	20100	16.20	15.30	11500	23580
	160%	12.70	5.90	8910	11280	12.70	7.70	10460	14610	15.90	9.60	11220	18130	16.50	11.50	11290	21810	17.10	13.60	12220	25700
7°C 44.6°F	40%	7.50	11.20	5240	5280	7.50	14.20	6360	6700	9.90	16.70	6790	7900	9.90	19.30	7060	9150	10.10	22.10	7220	10440
	70%	9.30	8.20	6480	6810	9.30	10.70	7750	8870	11.70	13.00	8240	10810	12.10	15.50	8570	12880	12.30	18.10	8800	15050
	100%	10.10	6.50	7100	7730	10.10	8.70	8490	10270	12.90	10.80	9100	12840	13.50	13.20	9560	15600	13.80	15.60	9880	18510
	130%	10.70	5.40	7470	8360	10.70	7.30	8980	11290	13.80	9.30	9710	14360	14.50	11.50	10290	17680	15.00	13.80	10720	21190
	160%	11.10	4.70	7740	8850	10.70	6.40	9350	12080	14.40	8.20	10180	15540	15.30	10.10	10850	19260	15.90	12.20	11350	23140
10°C 50°F	40%	6.40	9.40	4460	4460	6.40	12.00	5620	5660	8.80	14.40	6240	6810	9.30	17.00	6600	8030	9.60	19.70	6830	9310
	70%	8.60	6.80	5660	5660	8.60	8.80	6930	7300	10.70	11.00	7550	9140	11.20	13.40	7970	11150	11.60	16.00	8260	13280
	100%	8.50	5.00	5940	5950	8.50	7.00	7550	8280	11.70	9.00	8270	10720	12.40	11.30	8800	13400	12.90	13.70	9210	16270
	130%	9.00	4.10	6260	6300	9.00	5.80	7940	8980	12.40	7.70	8760	11900	13.30	9.80	9420	15140	13.90	12.10	9920	18610
	160%	9.30	3.40	6470	6540	9.30	5.00	8230	9520	12.90	6.80	9140	12830	13.90	8.70	9890	16510	14.70	10.80	10480	20410





Performance Data (3 Row)

Model : FC03	EWT : Entering Water Temperature	Qs : Sensible Cooling Capacity, W	DT _w : Water Temperature Differences , °C
Cooling Row : 3	EAT : Entering Air Temperature	Qt : Total Cooling Capacity, W	DT _A : Air Temperature Differences , °C
Flow rate, GPM			

Imperial Unit: BTU/h, °F

EWT	EAT (DB/WB)	23 °C / 16 °C				27 °C / 19 °C				30 °C / 22 °C				33 °C / 25 °C				36 °C / 28 °C			
	°F	73.4 oF / 60.8 oF				80.6 °F / 66.2 °F				86 °F / 71.6 °F				91.4 °F / 77.0 °F				96.8 °F / 82.4 °F			
	GPM	DT _A <°F>	DT _w <°F>	Qs	Qt	DT _A <°F>	DT _w <°F>	Qs	Qt	DT _A <°F>	DT _w <°F>	Qs	Qt	DT _A <°F>	DT _w <°F>	Qs	Qt	DT _A <°F>	DT _w <°F>	Qs	Qt
4°C 39.2 °F	40%	17.89	16.42	5874	6284	20.34	18.36	6762	8196	20.88	24.46	6865	9358	21.24	29.11	7035	11133	21.55	33.53	7104	12841
	70%	19.26	11.34	6386	7582	23.40	13.14	7752	10348	23.76	17.82	7957	11953	24.66	21.42	8265	14310	25.02	25.20	8504	16769
	100%	20.93	9.00	6899	8606	25.02	10.44	8333	11646	26.30	14.40	8640	14173	27.56	18.00	9084	17144	28.82	21.60	9494	20662
	130%	21.78	7.38	7206	9187	26.10	8.64	8675	12431	27.18	12.06	9084	14856	26.82	14.58	9631	17964	29.52	17.10	10006	21277
	160%	22.36	6.28	7377	9631	26.82	7.20	8948	12978	28.75	10.53	9460	16120	30.71	12.96	10109	19842	32.40	15.68	10655	24009
7°C 44.6 °F	40%	15.41	13.27	5089	5089	18.36	15.48	6113	6899	19.55	21.17	6421	8094	20.05	25.42	6591	9699	19.94	31.14	6557	10929
	70%	16.92	9.00	5601	6045	21.06	10.98	6967	8572	21.78	15.30	7274	10246	22.86	18.90	7684	12602	23.58	22.68	7992	15095
	100%	18.49	7.20	6079	6762	22.50	8.64	7445	9597	23.54	12.60	7752	11817	25.15	16.20	8265	14924	26.23	19.80	8640	18066
	130%	18.72	5.76	6216	7138	23.40	7.02	7752	10314	24.84	10.44	8299	12841	26.28	12.78	8845	15915	27.54	15.48	9289	19227
	160%	19.42	4.88	6386	7445	23.94	6.12	7992	10792	25.76	8.96	8470	13695	27.81	11.34	9153	17349	29.11	14.96	9597	20969
10°C 50 °F	40%	12.55	10.82	4132	4132	16.38	12.78	5464	5669	18.07	18.86	5942	6591	18.54	22.93	6113	8026	18.88	27.38	6216	9597
	70%	14.76	7.38	4884	4884	18.54	8.64	6181	6830	19.80	12.78	6591	8504	21.06	16.20	7069	10792	21.96	19.98	7445	13285
	100%	15.57	5.40	5123	5123	19.62	6.66	6557	7513	21.13	10.80	6967	9597	22.41	14.40	7377	12192	23.80	18.00	7821	15437
	130%	15.48	4.14	5157	5191	20.34	5.58	6762	7992	22.32	8.64	7445	10621	23.94	10.98	8060	13729	25.38	13.68	8606	17042
	160%	16.36	3.53	5396	5396	20.88	4.68	6933	8333	22.61	7.83	7445	10963	24.66	10.31	8128	14446	26.62	13.19	8777	18476





ELITE PRECISION COMPONENTS SDN. BHD. (Company No: 220355-X)
 No. 40 & 42, Jalan Anggerik Mokara 31/47, Kota Kemuning, 40460 Shah Alam, Selangor D.E., Malaysia.
 Tel: 603-5122 2893 Fax: 603-5122 5926/28 E-mail: info@eliteprecision.com Website: www.eliteprecision.com

SI Unit: W, °C

EWT	EAT (DB/WB)	23 °C / 16 °C				27 °C / 19 °C				30 °C / 22 °C				33 °C / 25 °C				36 °C / 28 °C			
	°F	73.4 oF / 60.8 oF				80.6 °F / 66.2 °F				86 °F / 71.6 °F				91.4 °F / 77.0 °F				96.8 °F / 82.4 °F			
	GPM	DT _A <°C>	DT _w <°C>	Q _s	Q _t	DT _A <°C>	DT _w <°C>	Q _s	Q _t	DT _A <°C>	DT _w <°C>	Q _s	Q _t	DT _A <°C>	DT _w <°C>	Q _s	Q _t	DT _A <°C>	DT _w <°C>	Q _s	Q _t
4°C	40%	9.94	9.12	1720	1840	11.30	10.20	1980	2400	11.60	13.59	2010	2740	11.80	16.17	2060	3260	11.97	18.63	2080	3760
	70%	10.70	6.30	1870	2220	13.00	7.30	2270	3030	13.20	9.90	2330	3500	13.70	11.90	2420	4190	13.90	14.00	2490	4910
	100%	11.63	5.00	2020	2520	13.90	5.80	2440	3410	14.61	8.00	2530	4150	15.31	10.00	2660	5020	16.01	12.00	2780	6050
	130%	12.10	4.10	2110	2690	14.50	4.80	2540	3640	15.10	6.70	2660	4350	14.90	8.10	2820	5260	16.40	9.50	2930	6230
39.2 °F	160%	12.42	3.49	2160	2820	14.90	4.00	2620	3800	15.97	5.85	2770	4720	17.06	7.20	2960	5810	18.00	8.71	3120	7030
7°C	40%	8.56	7.37	1490	1490	10.20	8.60	1790	2020	10.86	11.76	1880	2370	11.14	14.12	1930	2840	11.08	17.30	1920	3200
	70%	9.40	5.00	1640	1770	11.70	6.10	2040	2510	12.10	8.50	2130	3000	12.70	10.50	2250	3690	13.10	12.60	2340	4420
	100%	10.27	4.00	1780	1980	12.50	4.80	2180	2810	13.08	7.00	2270	3460	13.97	9.00	2420	4370	14.57	11.00	2530	5290
	130%	10.40	3.20	1820	2090	13.00	3.90	2270	3020	13.80	5.80	2430	3760	14.60	7.10	2590	4660	15.30	8.60	2720	5630
44.6 °F	160%	10.79	2.71	1870	2180	13.30	3.40	2340	3160	14.31	4.98	2480	4010	15.45	6.30	2680	5080	16.17	8.31	2810	6140
10°C	40%	6.97	6.01	1210	1210	9.10	7.10	1600	1660	10.04	10.48	1740	1930	10.30	12.74	1790	2350	10.49	15.21	1820	2810
	70%	8.20	4.10	1430	1430	10.30	4.80	1810	2000	11.00	7.10	1930	2490	11.70	9.00	2070	3160	12.20	11.10	2180	3890
	100%	8.65	3.00	1500	1500	10.90	3.70	1920	2200	11.74	6.00	2040	2810	12.45	8.00	2160	3570	13.22	10.00	2290	4520
	130%	8.60	2.30	1510	1520	11.30	3.10	1980	2340	12.40	4.80	2180	3110	13.30	6.10	2360	4020	14.10	7.60	2520	4990
50 °F	160%	9.09	1.96	1580	1580	11.60	2.60	2030	2440	12.56	4.35	2180	3210	13.70	5.73	2380	4230	14.79	7.33	2570	5410





ELITE PRECISION COMPONENTS SDN. BHD. (Company No: 220355-X)
 No. 40 & 42, Jalan Anggerik Mokara 31/47, Kota Kemuning, 40460 Shah Alam, Selangor D.E., Malaysia.
 Tel: 603-5122 2893 Fax: 603-5122 5926/28 E-mail: info@eliteprecision.com Website: www.eliteprecision.com

Model : FC04	EWT : Entering Water Temperature	Qs : Sensible Cooling Capacity, W	DT_w : Water Temperature Differences , °C
Cooling Row : 3	EAT : Entering Air Temperature	Qt : Total Cooling Capacity, W	DT_A : Air Temperature Differences , °C
Flow rate, GPM			

Imperial Unit: BTU/h, °F

EWT	EAT (DB/WB)	23 °C / 16 °C				27 °C / 19 °C				30 °C / 22 °C				33 °C / 25 °C				36 °C / 28 °C			
	°F	73.4 oF / 60.8 oF				80.6 °F / 66.2 °F				86 °F / 71.6 °F				91.4 °F / 77.0 °F				96.8 °F / 82.4 °F			
	GPM	DT _A <°F>	DT _w <°F>	Qs	Qt	DT _A <°F>	DT _w <°F>	Qs	Qt	DT _A <°F>	DT _w <°F>	Qs	Qt	DT _A <°F>	DT _w <°F>	Qs	Qt	DT _A <°F>	DT _w <°F>	Qs	Qt
4°C	40%	18.52	16.27	8128	8845	21.06	18.54	9323	11475	21.71	24.46	9528	13251	22.23	29.02	9733	15744	22.43	33.55	9836	18203
	70%	19.98	11.52	8845	10587	24.12	13.32	10690	14446	24.48	18.18	10929	16666	25.38	21.78	11407	19979	25.92	25.38	11748	23394
	100%	21.62	9.00	9460	11953	25.92	10.44	11509	16222	27.27	14.40	11953	19706	28.93	18.00	12670	24248	30.35	21.60	13285	29302
	130%	22.50	7.56	9938	12807	27.00	8.64	11987	17315	28.26	12.06	12568	20696	26.82	14.58	13285	25033	30.78	17.28	13866	29678
39.2°F	160%	23.24	6.21	10177	13490	27.72	7.20	12295	18032	29.74	10.30	13012	22335	31.82	12.67	13934	27492	33.84	15.44	14822	33503
7°C	40%	15.89	13.64	6967	6967	19.08	15.66	8504	9699	20.25	21.04	8879	11407	20.54	26.15	9016	13353	20.84	30.76	9119	15676
	70%	17.46	9.18	7718	8401	21.78	10.98	9631	11987	22.50	15.66	10041	14344	23.58	19.08	10621	17622	24.30	22.86	10997	21072
	100%	19.04	7.20	8333	9392	23.04	8.64	10280	13388	24.61	12.60	10792	16734	26.08	16.20	11441	20833	27.27	19.80	11953	25238
	130%	19.44	5.76	8572	9938	24.12	7.02	10690	14344	25.56	10.44	11407	17861	27.18	12.96	12226	22233	28.44	15.66	12909	26877
44.6°F	160%	19.98	5.06	8743	10314	24.66	6.12	10963	14993	26.84	8.89	11748	19262	28.78	11.81	12602	24077	30.69	14.58	13456	29746
10°C	40%	12.94	11.14	5669	5669	17.10	12.78	7548	7923	18.74	18.52	8196	9426	19.03	23.27	8333	11099	19.42	27.92	8504	13319
	70%	14.58	7.02	6455	6455	19.26	8.82	8504	9494	20.34	12.96	9084	11885	21.78	16.38	9733	15095	22.68	20.16	10246	18544
	100%	16.06	5.40	7035	7035	20.34	6.84	8982	10450	21.83	10.80	9563	13422	23.22	14.40	10177	17110	24.71	18.00	10826	21652
	130%	16.02	4.14	7104	7206	21.06	5.58	9323	11133	23.04	8.64	10246	14822	24.84	11.16	11133	19159	26.28	13.86	11851	23804
50°F	160%	17.01	3.65	7445	7445	21.42	4.68	9528	11612	23.60	7.63	10348	15539	25.63	10.60	11236	20218	27.45	13.36	12021	25511





ELITE PRECISION COMPONENTS SDN. BHD. (Company No: 220355-X)
 No. 40 & 42, Jalan Anggerik Mokara 31/47, Kota Kemuning, 40460 Shah Alam, Selangor D.E., Malaysia.
 Tel: 603-5122 2893 Fax: 603-5122 5926/28 E-mail: info@eliteprecision.com Website: www.eliteprecision.com

SI Unit: W, °C

EWT	EAT (DB/WB)	23 °C / 16 °C				27 °C / 19 °C				30 °C / 22 °C				33 °C / 25 °C				36 °C / 28 °C			
	°F	73.4 oF / 60.8 oF				80.6 °F / 66.2 °F				86 °F / 71.6 °F				91.4 °F / 77.0 °F				96.8 °F / 82.4 °F			
	GPM	DT _A <°C>	DT _W <°C>	Q _s	Q _t	DT _A <°C>	DT _W <°C>	Q _s	Q _t	DT _A <°C>	DT _W <°C>	Q _s	Q _t	DT _A <°C>	DT _W <°C>	Q _s	Q _t	DT _A <°C>	DT _W <°C>	Q _s	Q _t
4°C	40%	10.29	9.04	2380	2590	11.70	10.30	2730	3360	12.06	13.59	2790	3880	12.35	16.12	2850	4610	12.46	18.64	2880	5330
	70%	11.10	6.40	2590	3100	13.40	7.40	3130	4230	13.60	10.10	3200	4880	14.10	12.10	3340	5850	14.40	14.10	3440	6850
	100%	12.01	5.00	2770	3500	14.40	5.80	3370	4750	15.15	8.00	3500	5770	16.07	10.00	3710	7100	16.86	12.00	3890	8580
	130%	12.50	4.20	2910	3750	15.00	4.80	3510	5070	15.70	6.70	3680	6060	14.90	8.10	3890	7330	17.10	9.60	4060	8690
39.2 °F	160%	12.91	3.45	2980	3950	15.40	4.00	3600	5280	16.52	5.72	3810	6540	17.68	7.04	4080	8050	18.80	8.58	4340	9810
7°C	40%	8.83	7.58	2040	2040	10.60	8.70	2490	2840	11.25	11.69	2600	3340	11.41	14.53	2640	3910	11.58	17.09	2670	4590
	70%	9.70	5.10	2260	2460	12.10	6.10	2820	3510	12.50	8.70	2940	4200	13.10	10.60	3110	5160	13.50	12.70	3220	6170
	100%	10.58	4.00	2440	2750	12.80	4.80	3010	3920	13.67	7.00	3160	4900	14.49	9.00	3350	6100	15.15	11.00	3500	7390
	130%	10.80	3.20	2510	2910	13.40	3.90	3130	4200	14.20	5.80	3340	5230	15.10	7.20	3580	6510	15.80	8.70	3780	7870
44.6 °F	160%	11.10	2.81	2560	3020	13.70	3.40	3210	4390	14.91	4.94	3440	5640	15.99	6.56	3690	7050	17.05	8.10	3940	8710
10°C	40%	7.19	6.19	1660	1660	9.50	7.10	2210	2320	10.41	10.29	2400	2760	10.57	12.93	2440	3250	10.79	15.51	2490	3900
	70%	8.10	3.90	1890	1890	10.70	4.90	2490	2780	11.30	7.20	2660	3480	12.10	9.10	2850	4420	12.60	11.20	3000	5430
	100%	8.92	3.00	2060	2060	11.30	3.80	2630	3060	12.13	6.00	2800	3930	12.90	8.00	2980	5010	13.73	10.00	3170	6340
	130%	8.90	2.30	2080	2110	11.70	3.10	2730	3260	12.80	4.80	3000	4340	13.80	6.20	3260	5610	14.60	7.70	3470	6970
50 °F	160%	9.45	2.03	2180	2180	11.90	2.60	2790	3400	13.11	4.24	3030	4550	14.24	5.89	3290	5920	15.25	7.42	3520	7470





ELITE PRECISION COMPONENTS SDN. BHD. (Company No: 220355-X)
 No. 40 & 42, Jalan Anggerik Mokara 31/47, Kota Kemuning, 40460 Shah Alam, Selangor D.E., Malaysia.
 Tel: 603-5122 2893 Fax: 603-5122 5926/28 E-mail: info@eliteprecision.com Website: www.eliteprecision.com

Model : FC06	EWT : Entering Water Temperature	Qs : Sensible Cooling Capacity, W	DT _w : Water Temperature Differences , °C
Cooling Row : 3	EAT : Entering Air Temperature	Qt : Total Cooling Capacity, W	DT _A : Air Temperature Differences , °C
Flow rate, GPM			

Imperial Unit: BTU/h, °F

EWT	EAT (DB/WB)	23 °C / 16 °C				27 °C / 19 °C				30 °C / 22 °C				33 °C / 25 °C				36 °C / 28 °C			
	°F	73.4 oF / 60.8 oF				80.6 °F / 66.2 °F				86 °F / 71.6 °F				91.4 °F / 77.0 °F				96.8 °F / 82.4 °F			
	GPM	DT _A <°F>	DT _w <°F>	Qs	Qt	DT _A <°F>	DT _w <°F>	Qs	Qt	DT _A <°F>	DT _w <°F>	Qs	Qt	DT _A <°F>	DT _w <°F>	Qs	Qt	DT _A <°F>	DT _w <°F>	Qs	Qt
4°C	40%	17.57	16.54	11509	12124	19.80	18.36	13217	15881	20.70	24.10	13558	18442	20.79	28.80	13627	21140	21.04	33.48	13797	24555
	70%	18.90	11.52	12568	14719	22.86	13.32	15198	20013	23.22	18.00	15539	23087	23.94	21.42	16188	27629	24.48	25.02	16564	32273
	100%	20.52	9.00	13456	16598	24.48	10.44	16359	22643	25.70	14.40	16871	27356	27.20	18.00	17827	33605	28.08	21.60	18408	39889
	130%	21.42	7.56	14173	17896	25.56	8.64	17076	24248	26.64	12.06	17827	28892	27.72	14.58	18818	35	28.80	17.28	19535	41221
39.2 °F	160%	21.94	6.35	14378	18647	26.28	7.38	17588	25375	28.13	10.21	18442	31249	30.02	13.10	19671	38455	31.63	15.84	###	46515
7°C	40%	14.94	13.37	9802	9802	18.00	15.48	12021	13422	19.19	21.22	12602	15573	19.48	26.06	12773	18271	19.73	30.53	12944	21413
	70%	16.56	9.18	10997	11748	20.52	10.98	13695	16632	21.24	15.48	14241	19808	22.32	18.90	15061	24316	23.04	22.68	15607	29063
	100%	18.23	7.25	11953	13148	21.96	8.64	14617	18647	23.04	12.60	15129	22779	24.57	16.20	16120	28756	25.58	19.80	16769	34767
	130%	18.36	5.76	12226	13900	22.86	7.20	15266	20081	24.30	10.44	16256	24931	25.74	12.96	17315	30907	26.82	15.66	18203	37294
44.6 °F	160%	19.15	4.97	12568	14549	23.58	6.12	15676	21038	25.24	9.05	16564	26570	26.93	11.81	17656	33127	28.58	14.56	18749	40846
10°C	40%	12.24	10.96	8026	8026	16.02	12.78	10690	11031	17.87	18.45	11714	12909	17.98	23.40	11782	14890	18.49	27.38	12124	18305
	70%	14.40	7.38	9563	9563	18.18	8.82	12090	13217	19.44	12.78	12978	16495	20.52	16.20	13866	20833	21.42	19.80	14549	25546
	100%	15.25	5.40	10006	10006	19.26	6.84	12841	14617	20.72	10.80	13592	18510	21.92	14.40	14378	23462	23.24	18.00	15232	29678
	130%	15.30	4.32	10075	10143	19.98	5.58	13285	15539	21.78	8.64	14617	20594	23.58	11.16	15812	26638	24.84	13.86	16803	33025
50 °F	160%	16.20	3.64	10621	10621	20.52	4.68	13661	16290	22.45	7.74	14719	21686	24.05	10.89	15778	27731	25.90	13.25	16973	35450





ELITE PRECISION COMPONENTS SDN. BHD. (Company No: 220355-X)
 No. 40 & 42, Jalan Anggerik Mokara 31/47, Kota Kemuning, 40460 Shah Alam, Selangor D.E., Malaysia.
 Tel: 603-5122 2893 Fax: 603-5122 5926/28 E-mail: info@eliteprecision.com Website: www.eliteprecision.com

SI Unit: W, °C

EWT	EAT (DB/WB)	23 °C / 16 °C				27 °C / 19 °C				30 °C / 22 °C				33 °C / 25 °C				36 °C / 28 °C			
	°F	73.4 oF / 60.8 oF				80.6 °F / 66.2 °F				86 °F / 71.6 °F				91.4 °F / 77.0 °F				96.8 °F / 82.4 °F			
	GPM	DT _A <°C>	DT _w <°C>	Q _s	Q _t	DT _A <°C>	DT _w <°C>	Q _s	Q _t	DT _A <°C>	DT _w <°C>	Q _s	Q _t	DT _A <°C>	DT _w <°C>	Q _s	Q _t	DT _A <°C>	DT _w <°C>	Q _s	Q _t
4°C	40%	9.76	9.19	3370	3550	11.00	10.20	3870	4650	11.50	13.39	3970	5400	11.55	16.00	3990	6190	11.69	18.60	4040	7190
	70%	10.50	6.40	3680	4310	12.70	7.40	4450	5860	12.90	10.00	4550	6760	13.30	11.90	4740	8090	13.60	13.90	4850	9450
	100%	11.40	5.00	3940	4860	13.60	5.80	4790	6630	14.28	8.00	4940	8010	15.11	10.00	5220	9840	15.60	12.00	5390	11680
	130%	11.90	4.20	4150	5240	14.20	4.80	5000	7100	14.80	6.70	5220	8460	15.40	8.10	5510	10210	16.00	9.60	5720	12070
39.2°F	160%	12.19	3.53	4210	5460	14.60	4.10	5150	7430	15.63	5.67	5400	9150	16.68	7.28	5760	11260	17.57	8.80	6070	13620
7°C	40%	8.30	7.43	2870	2870	10.00	8.60	3520	3930	10.66	11.79	3690	4560	10.82	14.48	3740	5350	10.96	16.96	3790	6270
	70%	9.20	5.10	3220	3440	11.40	6.10	4010	4870	11.80	8.60	4170	5800	12.40	10.50	4410	7120	12.80	12.60	4570	8510
	100%	10.13	4.03	3500	3850	12.20	4.80	4280	5460	12.80	7.00	4430	6670	13.65	9.00	4720	8420	14.21	11.00	4910	10180
	130%	10.20	3.20	3580	4070	12.70	4.00	4470	5880	13.50	5.80	4760	7300	14.30	7.20	5070	9050	14.90	8.70	5330	10920
44.6°F	160%	10.64	2.76	3680	4260	13.10	3.40	4590	6160	14.02	5.03	4850	7780	14.96	6.56	5170	9700	15.88	8.09	5490	11960
10°C	40%	6.80	6.09	2350	2350	8.90	7.10	3130	3230	9.93	10.25	3430	3780	9.99	13.00	3450	4360	10.27	15.21	3550	5360
	70%	8.00	4.10	2800	2800	10.10	4.90	3540	3870	10.80	7.10	3800	4830	11.40	9.00	4060	6100	11.90	11.00	4260	7480
	100%	8.47	3.00	2930	2930	10.70	3.80	3760	4280	11.51	6.00	3980	5420	12.18	8.00	4210	6870	12.91	10.00	4460	8690
	130%	8.50	2.40	2950	2970	11.10	3.10	3890	4550	12.10	4.80	4280	6030	13.10	6.20	4630	7800	13.80	7.70	4920	9670
50°F	160%	9.00	2.02	3110	3110	11.40	2.60	4000	4770	12.47	4.30	4310	6350	13.36	6.05	4620	8120	14.39	7.36	4970	10380





ELITE PRECISION COMPONENTS SDN. BHD. (Company No: 220355-X)
 No. 40 & 42, Jalan Anggerik Mokara 31/47, Kota Kemuning, 40460 Shah Alam, Selangor D.E., Malaysia.
 Tel: 603-5122 2893 Fax: 603-5122 5926/28 E-mail: info@eliteprecision.com Website: www.eliteprecision.com

Model : FC08	EWT : Entering Water Temperature	Qs : Sensible Cooling Capacity, W	DT _w : Water Temperature Differences , °C
Cooling Row : 3	EAT : Entering Air Temperature	Qt : Total Cooling Capacity, W	DT _A : Air Temperature Differences , °C
Flow rate, GPM			

Imperial Unit: BTU/h, °F

EWT	EAT (DB/WB)	23 °C / 16 °C				27 °C / 19 °C				30 °C / 22 °C				33 °C / 25 °C				36 °C / 28 °C			
	°F	73.4 °F / 60.8 °F				80.6 °F / 66.2 °F				86 °F / 71.6 °F				91.4 °F / 77.0 °F				96.8 °F / 82.4 °F			
	GPM	DT _A <°F>	DT _w <°F>	Qs	Qt	DT _A <°F>	DT _w <°F>	Qs	Qt	DT _A <°F>	DT _w <°F>	Qs	Qt	DT _A <°F>	DT _w <°F>	Qs	Qt	DT _A <°F>	DT _w <°F>	Qs	Qt
4°C	40%	17.48	16.00	15300	15300	19.62	18.36	17452	20901	20.38	24.34	17861	24077	20.61	29.11	18066	27868	20.79	33.70	18203	32239
	70%	18.72	11.52	16598	19398	22.68	13.32	20081	26399	23.04	18.00	20491	30395	23.76	21.42	21345	36372	24.30	25.20	21891	42519
	100%	20.29	9.00	17759	21857	24.30	10.44	21618	29849	25.40	14.40	22233	35962	26.53	18.00	23257	43407	27.70	21.60	24282	52355
	130%	21.24	7.56	18715	23599	25.38	8.64	22574	32000	26.46	12.06	23565	38079	27.90	14.58	24828	45934	28.44	17.28	25785	54335
39.2 °F	160%	21.69	6.43	19023	24555	26.10	7.38	23189	33435	27.79	10.40	24350	41153	29.48	13.14	25819	50306	31.03	15.88	27185	60790
7°C	40%	14.78	13.54	12944	12944	17.82	15.66	15881	17691	18.97	21.33	16632	20389	19.30	26.05	16905	24077	19.55	30.53	17110	28209
	70%	16.38	9.18	14515	15471	20.34	10.98	18066	21891	21.06	15.48	18852	26092	22.14	18.90	19876	32034	22.86	22.68	20594	38284
	100%	18.09	7.20	15846	17452	21.78	8.64	19330	24589	22.99	12.60	20150	30395	24.25	16.20	21242	37738	25.24	19.80	22096	45627
	130%	18.36	5.76	16188	18340	22.68	7.20	20184	26468	24.12	10.44	21481	32854	25.56	12.96	22882	40743	26.46	15.66	24009	49110
44.6 °F	160%	18.88	4.99	16529	19057	23.40	6.12	20730	27765	24.95	9.14	21857	34971	26.60	11.79	23292	43578	28.22	14.54	24726	53755
10°C	40%	12.15	10.80	10655	10655	15.84	12.78	14105	14549	17.73	18.47	15539	17042	17.93	23.24	15710	19979	18.20	27.56	15949	23667
	70%	14.22	7.56	12636	12636	18.00	8.82	16017	17452	19.26	12.78	17110	21686	20.34	16.20	18340	27458	21.24	19.80	19227	33640
	100%	15.10	5.40	13217	13217	19.08	6.84	16973	19227	20.56	10.89	17998	24487	21.65	14.40	18988	30771	22.93	18.00	20081	38899
	130%	15.12	4.32	13319	13388	19.80	5.58	17588	2049	21.60	8.64	19330	27151	23.22	11.16	20935	35108	24.48	13.86	22199	43509
50 °F	160%	16.06	3.56	14071	14071	20.34	4.68	18032	21447	22.10	7.67	19364	28346	23.76	10.62	20833	36474	25.45	13.45	22301	46242





ELITE PRECISION COMPONENTS SDN. BHD. (Company No: 220355-X)
 No. 40 & 42, Jalan Anggerik Mokara 31/47, Kota Kemuning, 40460 Shah Alam, Selangor D.E., Malaysia.
 Tel: 603-5122 2893 Fax: 603-5122 5926/28 E-mail: info@eliteprecision.com Website: www.eliteprecision.com

SI Unit: W, °C

EWT	EAT (DB/WB)	23 °C / 16 °C				27 °C / 19 °C				30 °C / 22 °C				33 °C / 25 °C				36 °C / 28 °C			
	°F	73.4 oF / 60.8 oF				80.6 °F / 66.2 °F				86 °F / 71.6 °F				91.4 °F / 77.0 °F				96.8 °F / 82.4 °F			
	GPM	DT _A <°C>	DT _w <°C>	Q _s	Q _t	DT _A <°C>	DT _w <°C>	Q _s	Q _t	DT _A <°C>	DT _w <°C>	Q _s	Q _t	DT _A <°C>	DT _w <°C>	Q _s	Q _t	DT _A <°C>	DT _w <°C>	Q _s	Q _t
4°C	40%	9.71	8.89	4480	4480	10.90	10.20	5110	6120	11.32	13.52	5230	7050	11.45	16.17	5290	8160	11.55	18.72	5330	9440
	70%	10.40	6.40	4860	5680	12.60	7.40	5880	7730	12.80	10.00	6000	8900	13.20	11.90	6250	10650	13.50	14.00	6410	12450
	100%	11.27	5.00	5200	6400	13.50	5.80	6330	8740	14.11	8.00	6510	10530	14.74	10.00	6810	12710	15.39	12.00	7110	15330
	130%	11.80	4.20	5480	6910	14.10	4.80	6610	9370	14.70	6.70	6900	11150	15.50	8.10	7270	13450	15.80	9.60	7550	15910
	160%	12.05	3.57	5570	7190	14.50	4.10	6790	9790	15.44	5.78	7130	12050	16.38	7.30	7560	14730	17.24	8.82	7960	17800
7°C	40%	8.21	7.52	3790	3790	9.90	8.70	4650	5180	10.54	11.85	4870	5970	10.72	14.47	4950	7050	10.86	16.96	5010	8260
	70%	9.10	5.10	4250	4530	11.30	6.10	5290	6410	11.70	8.60	5520	7640	12.30	10.50	5820	9380	12.70	12.60	6030	11210
	100%	10.05	4.00	4640	5110	12.10	4.80	5660	7200	12.77	7.00	5900	8900	13.47	9.00	6220	11050	14.02	11.00	6470	13360
	130%	10.20	3.20	4740	5370	12.60	4.00	5910	7750	13.40	5.80	6290	9620	14.20	7.20	6700	11930	14.70	8.70	7030	14380
	160%	10.49	2.77	4840	5580	13.00	3.40	6070	8130	13.86	5.08	6400	10240	14.78	6.55	6820	12760	15.68	8.08	7240	15740
10°C	40%	6.75	6.00	3120	3120	8.80	7.10	4130	4260	9.85	10.26	4550	4990	9.96	12.91	4600	5850	10.11	15.31	4670	6930
	70%	7.90	4.20	3700	3700	10.00	4.90	4690	5110	10.70	7.10	5010	6350	11.30	9.00	5370	8040	11.80	11.00	5630	9850
	100%	8.39	3.00	3870	3870	10.60	3.80	4970	5630	11.42	6.05	5270	7170	12.03	8.00	5560	9010	12.74	10.00	5880	11390
	130%	8.40	2.40	3900	3920	11.00	3.10	5150	600	12.00	4.80	5660	7950	12.90	6.20	6130	10280	13.60	7.70	6500	12740
	160%	8.92	1.98	4120	4120	11.30	2.60	5280	6280	12.28	4.26	5670	8300	13.20	5.90	6100	10680	14.14	7.47	6530	13540





ELITE PRECISION COMPONENTS SDN. BHD. (Company No: 220355-X)
 No. 40 & 42, Jalan Anggerik Mokara 31/47, Kota Kemuning, 40460 Shah Alam, Selangor D.E., Malaysia.
 Tel: 603-5122 2893 Fax: 603-5122 5926/28 E-mail: info@eliteprecision.com Website: www.eliteprecision.com

Model : FC10	EWT : Entering Water Temperature	Qs : Sensible Cooling Capacity, W	DT_w : Water Temperature Differences , °C
Cooling Row : 3	EAT : Entering Air Temperature	Qt : Total Cooling Capacity, W	DT_A : Air Temperature Differences , °C
Flow rate, GPM			

Imperial Unit: BTU/h, °F

EWT	EAT (DB/WB)	23 °C / 16 °C				27 °C / 19 °C				30 °C / 22 °C				33 °C / 25 °C				36 °C / 28 °C			
	°F	73.4 oF / 60.8 oF				80.6 °F / 66.2 °F				86 °F / 71.6 °F				91.4 °F / 77.0 °F				96.8 °F / 82.4 °F			
	GPM	DT _A <°F>	DT _w <°F>	Qs	Qt	DT _A <°F>	DT _w <°F>	Qs	Qt	DT _A <°F>	DT _w <°F>	Qs	Qt	DT _A <°F>	DT _w <°F>	Qs	Qt	DT _A <°F>	DT _w <°F>	Qs	Qt
4°C	40%	17.01	15.75	18613	18613	19.08	18.36	21208	25102	19.98	24.03	21857	29131	20.23	28.71	22130	33879	20.41	33.25	22335	39240
	70%	18.18	11.34	20184	23360	21.96	13.14	24453	31181	22.32	17.82	24965	36542	23.22	21.42	25955	43714	23.58	24.84	26604	51057
	100%	19.84	9.00	21686	26433	23.76	10.44	26331	35996	24.77	14.40	27117	43441	25.83	18.00	28278	52423	26.95	21.60	29473	63181
	130%	20.70	7.56	22813	28483	24.84	8.64	27526	38694	25.74	12.06	28653	45934	29.70	14.58	30122	55360	27.72	17.28	31249	65367
39.2°F	160%	21.26	6.32	23257	29815	25.56	7.38	28312	40504	27.16	10.30	29712	49964	28.93	13.01	31625	61439	30.24	15.61	33059	73700
7°C	40%	14.31	13.27	15642	15642	17.46	15.48	19296	21277	18.65	21.06	20389	24828	18.85	25.87	20628	28858	19.10	30.33	20901	33810
	70%	16.02	9.18	17656	18681	19.80	10.98	22062	26399	20.52	15.30	22950	31385	21.60	18.72	24179	38455	22.14	22.32	25067	45934
	100%	17.73	7.20	19398	21106	21.24	8.64	23565	29644	22.43	12.60	24555	36713	23.40	16.20	25614	44671	24.55	19.80	26843	54916
	130%	17.82	5.76	19740	22130	22.14	7.20	24623	31966	23.40	10.44	26160	39616	24.84	12.96	27834	49076	25.74	15.48	29131	59083
44.6°F	160%	18.58	4.93	20320	23292	22.86	6.12	25341	33605	24.39	8.98	26673	42382	25.97	11.84	28414	52799	27.52	14.60	30088	65093
10°C	40%	11.75	10.93	12875	12875	15.48	12.78	14105	14549	17.28	18.68	18886	20218	17.46	23.24	19125	23667	17.78	27.74	19432	28244
	70%	13.86	7.56	15402	15402	17.64	8.82	19467	21038	18.72	12.78	20901	26126	19.98	16.02	22335	32956	20.70	19.62	23428	40402
	100%	14.62	5.40	15983	15983	18.72	6.84	20696	20764	20.02	10.80	21891	29268	21.11	14.40	23121	37021	22.09	18.00	24145	45832
	130%	14.58	4.32	16222	16256	19.44	5.58	21481	24760	21.06	8.64	23565	32683	22.68	11.16	25511	42280	23.94	13.68	26980	52321
50°F	160%	15.57	3.62	17042	17042	19.80	4.68	22028	25921	21.56	7.87	23599	34049	23.22	10.84	25409	44124	24.70	13.61	27014	55428





ELITE PRECISION COMPONENTS SDN. BHD. (Company No: 220355-X)
 No. 40 & 42, Jalan Anggerik Mokara 31/47, Kota Kemuning, 40460 Shah Alam, Selangor D.E., Malaysia.
 Tel: 603-5122 2893 Fax: 603-5122 5926/28 E-mail: info@eliteprecision.com Website: www.eliteprecision.com

SI Unit: W, °C

EWT	EAT (DB/WB)	23 °C / 16 °C				27 °C / 19 °C				30 °C / 22 °C				33 °C / 25 °C				36 °C / 28 °C			
	°F	73.4 oF / 60.8 oF				80.6 °F / 66.2 °F				86 °F / 71.6 °F				91.4 °F / 77.0 °F				96.8 °F / 82.4 °F			
	GPM	DT _A <°C>	DT _w <°C>	Q _s	Q _t	DT _A <°C>	DT _w <°C>	Q _s	Q _t	DT _A <°C>	DT _w <°C>	Q _s	Q _t	DT _A <°C>	DT _w <°C>	Q _s	Q _t	DT _A <°C>	DT _w <°C>	Q _s	Q _t
4°C	40%	9.45	8.75	5450	5450	10.60	10.20	6210	7350	11.10	13.35	6400	8530	11.24	15.95	6480	9920	11.34	18.47	6540	11490
	70%	10.10	6.30	5910	6840	12.20	7.30	7160	9130	12.40	9.90	7310	10700	12.90	11.90	7600	12800	13.10	13.80	7790	14950
	100%	11.02	5.00	6350	7740	13.20	5.80	7710	10540	13.76	8.00	7940	12720	14.35	10.00	8280	15350	14.97	12.00	8630	18500
	130%	11.50	4.20	6680	8340	13.80	4.80	8060	11330	14.30	6.70	8390	13450	16.50	8.10	8820	16210	15.40	9.60	9150	19140
39.2°F	160%	11.81	3.51	6810	8730	14.20	4.10	8290	11860	15.09	5.72	8700	14630	16.07	7.23	9260	17990	16.80	8.67	9680	21580
7°C	40%	7.95	7.37	4580	4580	9.70	8.60	5650	6230	10.36	11.70	5970	7270	10.47	14.37	6040	8450	10.61	16.85	6120	9900
	70%	8.90	5.10	5170	5470	11.00	6.10	6460	7730	11.40	8.50	6720	9190	12.00	10.40	7080	11260	12.30	12.40	7340	13450
	100%	9.85	4.00	5680	6180	11.80	4.80	6900	8680	12.46	7.00	7190	10750	13.00	9.00	7500	13080	13.64	11.00	7860	16080
	130%	9.90	3.20	5780	6480	12.30	4.00	7210	9360	13.00	5.80	7660	11600	13.80	7.20	8150	14370	14.30	8.60	8530	17300
44.6°F	160%	10.32	2.74	5950	6820	12.70	3.40	7420	9840	13.55	4.99	7810	12410	14.43	6.58	8320	15460	15.29	8.11	8810	19060
10°C	40%	6.53	6.07	3770	3770	8.60	7.10	4130	4260	9.60	10.38	5530	5920	9.70	12.91	5600	6930	9.88	15.41	5690	8270
	70%	7.70	4.20	4510	4510	9.80	4.90	5700	6160	10.40	7.10	6120	7650	11.10	8.90	6540	9650	11.50	10.90	6860	11830
	100%	8.12	3.00	4680	4680	10.40	3.80	6060	6080	11.12	6.00	6410	8570	11.73	8.00	6770	10840	12.27	10.00	7070	13420
	130%	8.10	2.40	4750	4760	10.80	3.10	6290	7250	11.70	4.80	6900	9570	12.60	6.20	7470	12380	13.30	7.60	7900	15320
50°F	160%	8.65	2.01	4990	4990	11.00	2.60	6450	7590	11.98	4.37	6910	9970	12.90	6.02	7440	12920	13.72	7.56	7910	16230





ELITE PRECISION COMPONENTS SDN. BHD. (Company No: 220355-X)
 No. 40 & 42, Jalan Anggerik Mokara 31/47, Kota Kemuning, 40460 Shah Alam, Selangor D.E., Malaysia.
 Tel: 603-5122 2893 Fax: 603-5122 5926/28 E-mail: info@eliteprecision.com Website: www.eliteprecision.com

Model : FC12	EWT : Entering Water Temperature	Qs : Sensible Cooling Capacity, W	DT _w : Water Temperature Differences , °C
Cooling Row : 3	EAT : Entering Air Temperature	Qt : Total Cooling Capacity, W	DT _A : Air Temperature Differences , °C
Flow rate, GPM			

Imperial Unit: BTU/h, °F

EWT	EAT (DB/WB)	23 °C / 16 °C				27 °C / 19 °C				30 °C / 22 °C				33 °C / 25 °C				36 °C / 28 °C			
	°F	73.4 oF / 60.8 oF				80.6 °F / 66.2 °F				86 °F / 71.6 °F				91.4 °F / 77.0 °F				96.8 °F / 82.4 °F			
	GPM	DT _A <°F>	DT _w <°F>	Qs	Qt	DT _A <°F>	DT _w <°F>	Qs	Qt	DT _A <°F>	DT _w <°F>	Qs	Qt	DT _A <°F>	DT _w <°F>	Qs	Qt	DT _A <°F>	DT _w <°F>	Qs	Qt
4°C	40%	16.85	15.73	22096	22096	19.08	18.36	25443	30122	19.91	24.19	26126	34732	20.16	28.75	26433	40367	20.32	33.25	26638	46685
	70%	18.18	11.52	24214	28039	21.96	13.32	29336	38148	22.32	17.82	29951	43885	23.22	21.42	31181	52491	23.58	25.02	31932	61337
	100%	19.82	9.00	25990	31693	23.76	10.44	31625	43236	24.75	14.40	32478	52081	25.83	18.00	33879	62839	26.93	21.60	35347	75749
	130%	20.70	7.56	27390	34220	24.84	8.64	32991	46412	25.74	12.06	34391	55155	28.62	14.58	36167	66494	27.72	17.28	37533	78515
39.2°F	160%	21.24	6.37	27868	35757	25.56	7.38	33947	48564	27.14	10.44	35620	59902	28.58	12.92	37499	72607	30.22	15.73	39650	88385
7°C	40%	14.15	13.54	18544	18544	17.46	15.48	23155	25511	18.59	21.11	24384	29610	18.83	25.85	24692	34596	19.08	30.33	25033	40606
	70%	16.02	9.18	21174	22404	19.80	10.98	26468	31693	20.52	15.30	27526	37669	21.60	18.72	29029	46173	22.14	22.50	30054	55155
	100%	17.59	7.20	23087	24897	21.24	8.64	28278	35586	22.43	12.60	29439	44022	23.51	16.34	30839	54062	24.53	19.80	32205	65845
	130%	17.82	5.76	23667	26570	22.14	7.20	29541	38352	23.40	10.44	31385	47539	24.84	12.96	33400	58912	25.74	15.66	35006	70967
44.6°F	160%	18.50	5.06	24282	27697	22.86	6.12	30361	40299	24.75	9.00	31829	50476	25.96	11.83	34049	63317	27.50	14.58	36064	78071
10°C	40%	11.75	10.76	15437	15437	15.48	12.78	20525	21038	17.30	18.70	22677	24419	17.55	23.24	23018	28858	17.78	27.38	23326	33981
	70%	13.86	7.56	18476	18476	17.46	8.82	23394	25272	18.72	12.78	25067	31351	19.98	16.20	26809	39582	20.70	19.80	28107	48496
	100%	14.62	5.40	19193	19193	18.72	6.84	24828	27868	20.00	10.80	26263	35108	21.10	14.40	27697	44363	22.30	18.00	29268	56043
	130%	14.58	4.32	19467	19501	19.26	5.58	25750	29712	21.06	8.64	28278	39240	22.68	11.16	30566	50750	23.94	13.68	32376	62805
50°F	160%	15.57	3.56	20423	20423	19.80	4.68	26433	31112	21.55	7.83	28244	40846	23.22	10.66	30463	52901	24.70	13.39	32376	66494





ELITE PRECISION COMPONENTS SDN. BHD. (Company No: 220355-X)
 No. 40 & 42, Jalan Anggerik Mokara 31/47, Kota Kemuning, 40460 Shah Alam, Selangor D.E., Malaysia.
 Tel: 603-5122 2893 Fax: 603-5122 5926/28 E-mail: info@eliteprecision.com Website: www.eliteprecision.com

SI Unit: W, °C

EWT	EAT (DB/WB)	23 °C / 16 °C				27 °C / 19 °C				30 °C / 22 °C				33 °C / 25 °C				36 °C / 28 °C			
	°F	73.4 oF / 60.8 oF				80.6 °F / 66.2 °F				86 °F / 71.6 °F				91.4 °F / 77.0 °F				96.8 °F / 82.4 °F			
	GPM	DT _A <°F>	DT <°C>	Q _s	Q _t	DT _A <°F>	DT <°C>	Q _s	Q _t		DT <°C>	Q _s	Q _t		DT <°C>	Q _s	Q _t		DT <°C>	Q _s	Q _t
4°C	40%	9.36	8.74	6470	6470	10.60	10.20	7450	8820	11.06	13.44	7650	10170	11.20	15.97	7740	11820	11.29	18.47	7800	13670
	70%	10.10	6.40	7090	8210	12.20	7.40	8590	11170	12.40	9.90	8770	12850	12.90	11.90	9130	15370	13.10	13.90	9350	17960
	100%	11.01	5.00	7610	9280	13.20	5.80	9260	12660	13.75	8.00	9510	15250	14.35	10.00	9920	18400	14.96	12.00	10350	22180
	130%	11.50	4.20	8020	10020	13.80	4.80	9660	13590	14.30	6.70	10070	16150	15.90	8.10	10590	19470	15.40	9.60	10990	22990
39.2°F	160%	11.80	3.54	8160	10470	14.20	4.10	9940	14220	15.08	5.80	10430	17540	15.88	7.18	10980	21260	16.79	8.74	11610	25880
7°C	40%	7.86	7.52	5430	5430	9.70	8.60	6780	7470	10.33	11.73	7140	8670	10.46	14.36	7230	10130	10.60	16.85	7330	11890
	70%	8.90	5.10	6200	6560	11.00	6.10	7750	9280	11.40	8.50	8060	11030	12.00	10.40	8500	13520	12.30	12.50	8800	16150
	100%	9.77	4.00	6760	7290	11.80	4.80	8280	10420	12.46	7.00	8620	12890	13.06	9.08	9030	15830	13.63	11.00	9430	19280
	130%	9.90	3.20	6930	7780	12.30	4.00	8650	11230	13.00	5.80	9190	13920	13.80	7.20	9780	17250	14.30	8.70	10250	20780
44.6°F	160%	10.28	2.81	7110	8110	12.70	3.40	8890	11800	13.75	5.00	9320	14780	14.42	6.57	9970	18540	15.28	8.10	10560	22860
10°C	40%	6.53	5.98	4520	4520	8.60	7.10	6010	6160	9.61	10.39	6640	7150	9.75	12.91	6740	8450	9.88	15.21	6830	9950
	70%	7.70	4.20	5410	5410	9.70	4.90	6850	7400	10.40	7.10	7340	9180	11.10	9.00	7850	11590	11.50	11.00	8230	14200
	100%	8.12	3.00	5620	5620	10.40	3.80	7270	8160	11.11	6.00	7690	10280	11.72	8.00	8110	12990	12.39	10.00	8570	16410
	130%	8.10	2.40	5700	5710	10.70	3.10	7540	8700	11.70	4.80	8280	11490	12.60	6.20	8950	14860	13.30	7.60	9480	18390
50°F	160%	8.65	1.98	5980	5980	11.00	2.60	7740	9110	11.97	4.35	8270	11960	12.90	5.92	8920	15490	13.72	7.44	9480	19470





Water Flow VS Pressure Drop (4 Row)

Model	Flow Rate		Drop	
	Litres/Min	USGGPM	KPA	PSI
FC03	1.6	0.4	2.1	0.3
	2.8	0.7	6.1	0.9
	4.0	1.1	11.1	1.6
	5.2	1.4	17.2	2.5
	6.4	1.7	24.6	3.6
FC04	2.9	0.8	2.2	0.3
	5.1	1.3	7.0	1.0
	7.3	1.9	12.9	1.9
	9.5	2.5	20.4	3.0
	11.7	3.1	29.0	4.2
FC06	4.0	1.1	3.4	0.5
	6.9	1.8	13.2	1.9
	9.8	2.6	24.4	3.5
	12.8	3.4	38.4	5.6
	15.7	4.1	55.0	8.0
FC08	4.4	1.2	2.5	0.4
	7.7	2.0	8.7	1.3
	11.0	2.9	16.1	2.3
	14.3	3.8	24.7	3.6
	17.6	4.6	36.3	5.3
FC10	6.0	1.6	2.5	0.4
	10.5	2.8	9.2	1.3
	15.0	4.0	16.9	2.5
	19.5	5.2	26.6	3.9
	24.0	6.3	38.3	5.6
FC12	6.8	1.8	3.2	0.5
	11.9	3.1	12.8	1.9
	17.0	4.5	23.6	3.4
	22.1	5.8	37.3	5.4
	27.2	7.2	53.6	7.8





Water Flow VS Pressure Drop (3 Row)

Model	Flow Rate		Drop	
	Litres/Min	USGGPM	KPA	PSI
FC03	3.4	0.9	4.3	0.6
	5.0	1.3	12.7	1.8
	8.5	2.2	23.1	3.3
	9.4	2.5	37.3	5.4
	13.4	3.5	54.4	7.9
FC04	4.8	1.3	3.5	0.5
	7.0	1.8	9.4	1.4
	11.7	3.1	18.2	2.6
	13.0	3.4	27.7	4.0
	19.2	5.1	45.1	6.5
FC06	6.5	1.7	3.3	0.5
	9.7	2.6	9.0	1.3
	16.3	4.3	18.1	2.6
	18.1	4.8	26.7	3.9
	25.9	6.8	42.8	6.2
FC08	8.6	2.3	3.9	0.6
	12.8	3.4	9.6	1.4
	21.4	5.7	21.1	3.1
	23.8	6.3	28.7	4.2
	34.6	9.1	51.2	7.4
FC10	10.3	2.7	3.8	0.6
	15.5	4.1	9.5	1.4
	25.9	6.8	21.0	3.0
	28.7	7.6	28.4	4.1
	41.3	10.9	50.1	7.3
FC12	12.5	3.3	3.1	0.4
	18.5	4.9	10.2	1.5
	31.1	8.2	16.8	2.4
	34.4	9.1	31.1	4.5
	49.9	13.2	40.4	5.9



Cooling Capacity vs Speed Correction Factor

Fan Speed		Total Cooling Capacity	Sensible Cooling Capacity
High Static Motor	Low Static Motor		
Medium	High	0.91	0.90
Low	Medium	0.80	0.78
	Low	0.68	0.66

Selection Procedure

Select a unit for cooling by matching design sensible cooling capacity to unit sensible cooling capacity.

Example:

I. Selection at highest fan speed

Units are usually selected for cooling at highest fan speed to ensure use of the smallest size unit.

1.0 Determine job requirements

Given: Room sensible cooling capacity = 3000w

Room total cooling capacity = 3915w

Entering air temperature = 27 °Cdb, 19 °Cwb

Entering water temperature = 7 °C

Leaving water temperature = 12 °C

Air flow rate = 388 CFM



2.0 Determine Water Temperature Differences

If water temperature differences greater than 5 °C, the unit is high ΔT. Else, the unit is low ΔT. Refer performance table (4 row) if it is high ΔT, refer performance table (3 row) if it is low ΔT.

$$\begin{aligned} \text{Water temperature differences} &= \text{Leaving water temperature} - \text{Entering water temperature} \\ &= 12\text{ }^{\circ}\text{C} - 7\text{ }^{\circ}\text{C} \\ &= 5\text{ }^{\circ}\text{C} \end{aligned}$$

Low ΔT, refer Performance Table (3 row).

Determine unit size, water flow rate and pressure drop

Find air flow rate equal to or greater than that required. Required air flow rate is 388 CFM, select **FC04** (400CFM) which closer and greater.

Find entering air and water temperature of 27 °Cdb, 19 °Cwb and 7 °C.

Find sensible cooling capacity equal to or greater than that required. Read **3010w** sensible cooling capacity; **3920w** total cooling capacity. Read left to select water flow rate 100%.

Refer Water Flow vs Pressure Drop (3 Row) table, find model **FC04**, read right **100%** water flow rate at **11.7 l/min** with **18.2 kPa** water pressure drop.

Selected fan coil unit size is **FC04**, water flow rate **11.7 l/min**, water pressure drop **18.2 kPa**, low ΔT.

Capacity at high, medium or low fan speed may be calculated by using

-**Cooling Capacity vs Speed Correction Factor** table.



II. Selection at second high fan speed

A common practice is to operate fans most of the time at second high, medium or low speed. Units, therefore, may be selected on the basis of an average cooling capacity condition and at second high fan speed. Operation at high fan speed allows for unusual or peak load requirements.

1.0 Determine job requirements

Given: Average design room sensible cooling capacity = 2790w

Average design room total cooling capacity = 3490w

Entering air temperature = 27 °Cdb, 19 °Cwb

Entering water temperature = 7 °C

Leaving water temperature = 14.5 °C

Air flow rate = 290 CFM

Motor type = high static motor

2.0 Determine Water Temperature Differences

If water temperature differences greater than 5 °C, The unit is high ΔT . Else, the unit is low ΔT . Refer performance table (4 row) if it is high ΔT , refer performance table (3 row) if it is low ΔT .

$$\begin{aligned} \text{Water temperature differences} &= \text{Leaving water temperature} - \text{Entering water temperature} \\ &= 7.5 \text{ }^\circ\text{C} \end{aligned}$$

High ΔT , refer Performance Table (4 row).



3.0 Determine unit size, water flow rate and pressure drop

3.1 Find air flow rate equal to or greater than that required. Required air flow rate is 290 CFM, Read **FC03** (300CFM) which is closer and greater select one size up which is **FC04** (400CFM).

3.2 Find entering air and water temperature of 27 °Cdb, 19 °Cwb and 7 °C.

3.3 Determine second high fan speed cooling capacity correction factor, using Cooling Capacity vs Speed Correction Factor table.

Second high fan speed for high static motor is medium speed; the sensible and total cooling capacity correction factor is 0.90 and 0.91.

3.4 Determine corrected sensible and total cooling capacity by dividing average design capacity by the selected correction factor.

$$\begin{aligned} \text{Corrected sensible} &= \frac{2790}{0.90} \\ \text{cooling capacity} & \\ &= \mathbf{3100w} \end{aligned}$$

$$\begin{aligned} \text{Corrected total} &= \frac{3490}{0.91} \\ \text{cooling capacity} & \\ &= \mathbf{3835w} \end{aligned}$$

Find sensible cooling capacity equal to or greater than corrected capacity. Read **3110w** sensible cooling capacity; **3850w** total cooling capacity. Read left to select water flow rate 100%.

Refer Water Flow vs Pressure Drop (4 Row) table, find model FC04, read right 100% water flow rate at 7.3 l/min with 12.9 kPa water pressure drop.

Selected fan coil unit size is FC04, water flow rate **7.3 l/min**, water pressure drop **12.9 kPa**, **high ΔT**, high static motor.





Table 1: Low Static Motor

General Data

MODEL, LOW ΔT		FC03	FC04	FC06	FC08	FC10	FC12
Nominal Cooling Capacity	BTU/HR	10300	14400	19900	26000	31100	37300
	W	3000	4200	5800	7600	9100	10900
Nominal Sensible Cooling Capacity	BTU/HR	7600	10300	14400	18800	22900	27700
	W	2200	3000	4200	5500	6700	8100
Power Supply	V/Ph/Hz	220 ~240 / 1 / 50					
Motor Type		4 Speed Permanent Split Capacitor					
Max Unit Running Amp	A x Qty	0.36	0.48	0.65	0.92	0.37+0.70	0.68+0.68
Output Power	w x Qty	32	50	65	100	40+70	75+75
Air Flow	l/s (CFM)	142 (300)	189 (400)	282 (600)	378 (800)	472 (1000)	567 (1200)
External Static Pressure (H/M/L)	Pa	30	30	30	30	30	30
Fan Coil Water Volume / Mass	cm ³	795	1179	1439	1763	2066	2437
Condensate Drain Size	mm (in)	12.7 (1/2")	12.7 (1/2")	12.7 (1/2")	12.7 (1/2")	12.7 (1/2")	12.7 (1/2")
Nominal Water Flow Rate	USGPM	2.2	3.1	4.3	5.7	6.8	8.2
	LITRES/M	8	12	16	21	26	31
Head Loss	kpa	23	18	18	21	21	17
Max Working Pressure	kpa (psi)	1600 (2300)					
Connection (Thread Type)	Inch (mm)	3/4" (NPT) 19.0					
Unit Weight	kg (lb)	17	22	26	30	37	43
Sound Pressure Level	dBA	46.5	48.6	48.0	52.8	51.0	53.5

MODEL, HIGH ΔT		FC03	FC04	FC06	FC08	FC10	FC12
Nominal Cooling Capacity	BTU/HR	9600	13300	18100	23600	28300	33800
	W	2800	3900	5300	6900	8300	9900
Nominal Sensible Cooling Capacity	BTU/HR	7400	10800	14900	19800	24800	29600
	W	2200	3200	4400	5800	7300	8700
Power Supply	V/Ph/Hz	220 ~240 / 1 / 50					
Motor Type		4 Speed Permanent Split Capacitor					
Max Unit Running Amp	A x Qty	0.36	0.48	0.65	0.92	0.37+0.70	0.68+0.68
Output Power	w x Qty	32	50	65	100	40+70	75+75
Air Flow	l/s (CFM)	142 (300)	189 (400)	282 (600)	378 (800)	472 (1000)	567 (1200)
External Static Pressure (H/M/L)	Pa	30	30	30	30	30	30
Fan Coil Water Volume / Mass	cm ³	795	1179	1439	1763	2066	2437
Condensate Drain Size	mm (in)	12.7 (1/2")	12.7 (1/2")	12.7 (1/2")	12.7 (1/2")	12.7 (1/2")	12.7 (1/2")
Nominal Water Flow Rate	USGPM	1.1	2.1	2.6	2.9	4.0	4.5
	LITRES/M	4	8	10	11	15	17
Head Loss	kpa	11	13	24	16	17	23
Max Working Pressure	kpa (psi)	1600 (2300)					
Connection (Thread Type)	Inch (mm)	3/4" (NPT) 19.0					
Unit Weight	kg (lb)	18	23	27	32	39	45
Sound Pressure Level	dBA	46.5	48.6	48.0	52.8	51.0	53.5





Components Data

MODEL			FC03	FC04	FC06	FC08	FC10	FC12	
Casing	Outline Dimension	Length	mm	805	1051	1224	1470	1642	1889
		Depth	mm	458 (without plenum) / 488 (with plenum and filter)					
		Height	mm	270					
	Material		GI						
	External Finishing		Bare GI						
Insulation		PE / 5mm							
Fan	Qty		1	1	2	2	3	4	
	Material		GALVANIZED STEEL	GALVANIZED STEEL	GALVANIZED STEEL	GALVANIZED STEEL	GALVANIZED STEEL	GALVANIZED STEEL	
	Diameter	mm/in	160	160	160	160	160	160	
	Length	mm/in	200	200	200	200	200	200	
	Drive	Direct/Belt	Direct	Direct	Direct	Direct	Direct	Direct	
	Pulley, Blower		-	-	-	-	-	-	
	Pulley, Motor		-	-	-	-	-	-	
	Belt		-	-	-	-	-	-	
Fan Motor	Type		Capacitor Run Motor	Capacitor Run Motor	Capacitor Run Motor	Capacitor Run Motor	Capacitor Run Motor	Capacitor Run Motor	
	Qty		1	1	1	1	2	2	
	Index of Protection (IP)		IP 20	IP 20	IP 20	IP 20	IP 20	IP 20	
	Insulation Grade		B	B	B	B	B	B	
	Power Source (V/Ph/Hz)		220 ~240 / 1 / 50						
	Poles		4	4	4	4	4	4	
	Capacitor	µF	2.5	3.0	3.5	5.0	2.5+3.5	4.0+4.0	
	Rated Running Current	A	0.36	0.48	0.65	0.92	0.37+0.70	0.68+0.68	
Motor Output	W	32.0	50.0	65.0	100.0	40+70	75+75		
Coil	Tube	Material	Cu						
		Diameter	mm/in	9.52	9.52	9.52	9.52	9.52	9.52
		Thickness	mm/in	0.3	0.3	0.3	0.3	0.3	0.3
	Fin	Material	Al						
		Thickness	mm/in	0.11	0.11	0.11	0.11	0.11	0.11
		Face Area	m2 (ft ²)	0.095 (1.020)	0.145 (1.56)	0.18 (1.94)	0.23 (2.48)	0.265 (2.85)	0.315 (3.39)
	MODEL, LOW ΔT	Row	3	3	3	3	3	3	
	MODEL, HIGH ΔT		4	4	4	4	4	4	
	Fin per inch	FPI	12	12	12	12	12	12	
Filtration	Type		Washable Aluminum Frame Filter / G2						
	Quantity	pc	1	2	2	3	3	4	
	Dimension (L x W x T)	mm	488x243x12	734x243x12	906x243x12	1152x243x12	1324x243x12	1570x243x12	





Table 2: High Static Motor

General Data

MODEL, LOW ΔT		FC03	FC04	FC06	FC08	FC10	FC12
Nominal Cooling Capacity	BTU/HR	10300	14400	19900	26000	31100	37300
	W	3000	4200	5800	7600	9100	10900
Nominal Sensible Cooling Capacity	BTU/HR	7600	10300	14400	18800	22900	27700
	W	2200	3000	4200	5500	6700	8100
Power Supply	V/Ph/Hz	220 ~240 / 1 / 50					
Motor Type		3 Speed Permanent Split Capacitor					
Max Unit Running Amp	A x Qty	0.40	0.70	0.75	1.00	0.40+1.00	0.75+0.75
Output Power	w x Qty	50	72	100	120	50+120	100+100
Air Flow	l/s (CFM)	142 (300)	189 (400)	282 (600)	378 (800)	472 (1000)	567 (1200)
External Statics Pressure (H/M/L)	Pa	70	70	70	70	70	70
Fan Coil Water Volume / Mass	cm ³	795	1179	1439	1763	2066	2437
Condensate Drain Size	mm (in)	12.7 (1/2")	12.7 (1/2")	12.7 (1/2")	12.7 (1/2")	12.7 (1/2")	12.7 (1/2")
Nominal Water Flow Rate	USGPM	2.2	3.1	4.3	5.7	6.8	8.2
	LITRES/M	8	12	16	21	26	31
Head Loss	kpa	23	18	18	21	21	17
Max Working Pressure	kpa (psi)	1600 (2300)					
Connection (Thread Type)	Inch (mm)	3/4" (NPT) 19.0					
Unit Weight	kg (lb)	17	22	26	30	37	43
Sound Pressure Level	dBA	TBC	TBC	TBC	TBC	TBC	TBC

MODEL, HIGH ΔT		FC03	FC04	FC06	FC08	FC10	FC12
Nominal Cooling Capacity	BTU/HR	9600	13300	18100	23600	28300	33800
	W	2800	3900	5300	6900	8300	9900
Nominal Sensible Cooling Capacity	BTU/HR	7400	10800	14900	19800	24800	29600
	W	2200	3200	4400	5800	7300	8700
Power Supply	V/Ph/Hz	220 ~240 / 1 / 50					
Motor Type		3 Speed Permanent Split Capacitor					
Max Unit Running Amp	A x Qty	0.40	0.70	0.75	1.00	0.40+1.00	0.75+0.75
Output Power	w x Qty	50	72	100	120	50+120	100+100
Air Flow	l/s (CFM)	142 (300)	189 (400)	282 (600)	378 (800)	472 (1000)	567 (1200)
External Statics Pressure (H/M/L)	Pa	70	70	70	70	70	70
Fan Coil Water Volume / Mass	cm ³	795	1179	1439	1763	2066	2437
Condensate Drain Size	mm (in)	12.7 (1/2")	12.7 (1/2")	12.7 (1/2")	12.7 (1/2")	12.7 (1/2")	12.7 (1/2")
Nominal Water Flow Rate	USGPM	2.2	3.1	4.3	5.7	6.8	8.2
	LITRES/M	8	12	16	21	26	31
Head Loss	kpa	23	18	18	21	21	17
Max Working Pressure	kpa (psi)	1600 (2300)					
Connection (Thread Type)	Inch (mm)	3/4" (NPT) 19.0					
Unit Weight	kg (lb)	18	23	27	32	39	45
Sound Pressure Level	dBA	TBC	TBC	TBC	TBC	TBC	TBC





Components Data

MODEL			FC03	FC04	FC06	FC08	FC10	FC12	
Casing	Outline Dimension	Length	mm	805	1051	1224	1470	1642	1889
		Depth	mm	458 (without plenum) / 488 (with plenum and filter)					
		Height	mm	270					
	Material	GI							
	External Finishing	Bare GI							
Insulation	PE / 5mm								
Fan	Qty		1	1	2	2	3	4	
	Material		GALVANIZED STEEL	GALVANIZED STEEL	GALVANIZED STEEL	GALVANIZED STEEL	GALVANIZED STEEL	GALVANIZED STEEL	
	Diameter	mm/in	160	160	160	160	160	160	
	Length	mm/in	200	200	200	200	200	200	
	Drive	Direct/Belt	Direct	Direct	Direct	Direct	Direct	Direct	
	Pulley, Blower		-	-	-	-	-	-	
	Pulley, Motor		-	-	-	-	-	-	
	Belt		-	-	-	-	-	-	
Fan Motor	Type		Capacitor Run Motor	Capacitor Run Motor	Capacitor Run Motor	Capacitor Run Motor	Capacitor Run Motor	Capacitor Run Motor	
	Qty		1	1	1	1	2	2	
	Index of Protection (IP)		IP 20	IP 20	IP 20	IP 20	IP 20	IP 20	
	Insulation Grade		B	B	B	B	B	B	
	Power Source (V/Ph/Hz)		220 ~240 / 1 / 50						
	Poles		4	4	4	4	4	4	
	Capacitor	µF	3.0	3.5	4.0	5.0	3.0+5.0	4.0+4.0	
	Rated Running Current	A	0.40	0.70	0.75	1.00	0.40+1.00	0.75+0.75	
Motor Output	W	50.0	72.0	100.0	120.0	50+120	100+100		
Coil	Tube	Material	Cu						
		Diameter	mm/in	9.52	9.52	9.52	9.52	9.52	9.52
		Thickness	mm/in	0.3	0.3	0.3	0.3	0.3	0.3
	Fin	Material	Al						
		Thickness	mm/in	0.11	0.11	0.11	0.11	0.11	0.11
		Face Area	m2 (ft ²)	0.095 (1.020)	0.145 (1.56)	0.18 (1.94)	0.23 (2.48)	0.265 (2.85)	0.315 (3.39)
	MODEL, LOW ΔT	Row		3	3	3	3	3	3
	MODEL, HIGH ΔT			4	4	4	4	4	4
	Fin per inch	FPI	12	12	12	12	12	12	
Filtration	Type		Washable Aluminum Frame Filter / G2						
	Quantity	pc	1	2	2	3	3	4	
	Dimension (L x W x T)	mm	488x243x12	734x243x12	906x243x12	1152x243x12	1324x243x12	1570x243x12	



Table 3

Dimension

MODEL		FC03	FC04	FC06	FC08	FC10	FC12
A	(mm)	458	458	458	458	458	458
B	(mm)	488	488	488	488	488	488
C	(mm)	270	270	270	270	270	270
D	(mm)	805	1051	1224	1470	1642	1889
E	(mm)	775	1021	1194	1440	1612	1859
F	(mm)	612	858	1031	1277	1449	1696
G	(mm)	520	766	939	1185	1357	1604
H	(mm)	151	151	151	151	151	151
I	(mm)	470	716	889	1135	1307	1554

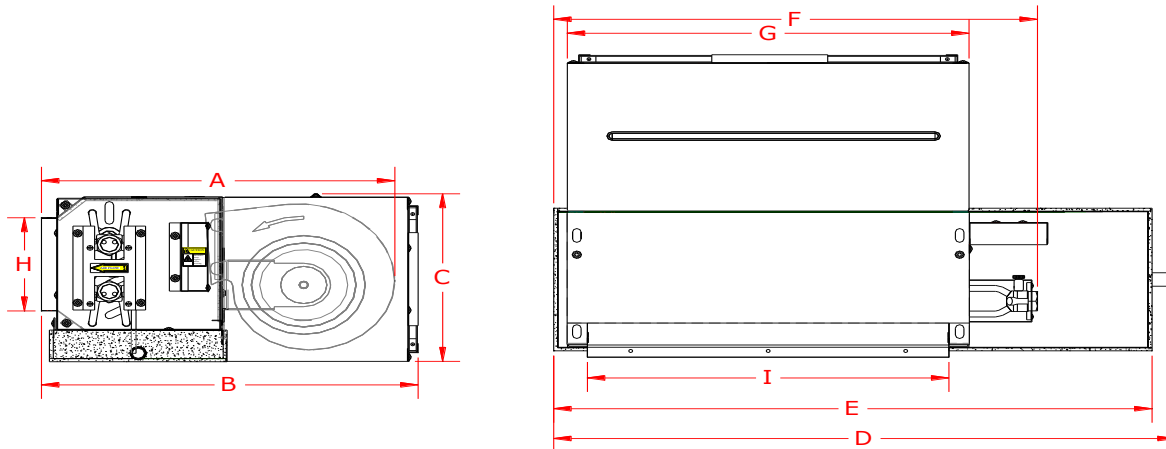

Note:

1. All specifications are subjected to change by the manufacturer without prior notice
2. For Model, Low ΔT Nominal cooling capacities are based on the below conditions:
 - a) Entering air temperature 27 degC (80.6 degF) DB and 19 degC (66.2 deg F) WB
 - b) Entering water temperature 7 degC (44.6 degF)
 - c) Leaving water temperature 12 degC (53.6 degF)
3. For Model, High ΔT Nominal cooling capacities are based on the below conditions:
 - a) Entering air temperature 27 degC (80.6 degF) DB and 19 degC (66.2 deg F) WB
 - b) Entering water temperature 7 degC (44.6 degF)
 - c) Leaving water temperature 15 degC (58.5 degF)